

D-M-E Close Tolerance Through-Hard Ejector Pins

Industry-leading tolerance

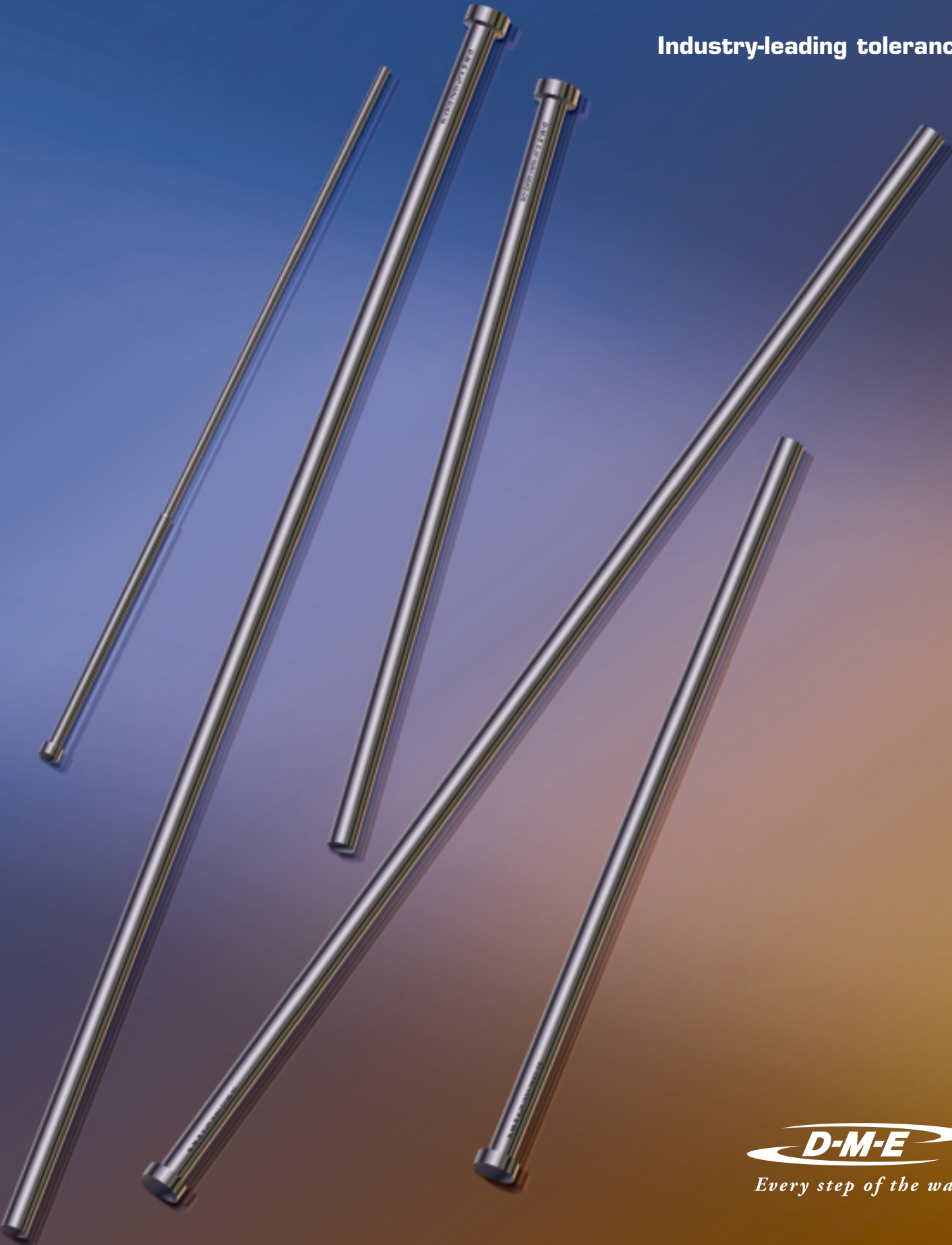

D-M-E Standard Close Tolerance Through-Hard Ejector Pins

AMERICAN
STANDARD
INCH

Featuring an industry-leading .0002" tolerance band



INFORMATION KEY:

D = Pin Body Diameter
H = Head Diameter
K = Head Thickness
L = Length
S = Shoulder Length
Tolerance on Ø D: -.0003/-.0005
Material: M2 / 1.3343 / SKH51
Heat Treat: Hardened 58-62 HRC
Surface Treatment: None (Through-Hard)

- Industry-leading .0002" tolerance band
- Centerless ground "D" diameter
- Precision made of superior quality high-speed steel
- Superior wear resistance
- Exceptional performance at elevated temperatures
- Hot-forged heads provide uniform grain flow, higher tensile strength

Straight Ejector Pins

ITEM NUMBER PREFIX (WITH DIAMETER)	Ø D PIN BODY DIAMETER	Ø H HEAD DIAMETER	K HEAD THICKNESS	L = 06 LENGTH (Inches)	L = 10 LENGTH (Inches)
EJP-IMH-0062-	1/16 (0.0625)	1/4	1/8	⚡	
EJP-IMH-0093-	3/32 (0.0937)	1/4	1/8	⚡	
EJP-IMH-0125-	1/8 (0.1250)	1/4	1/8	⚡	⚡
EJP-IMH-0187-	3/16 (0.1875)	3/8	3/16		⚡
EJP-IMH-0250-	1/4 (0.2500)	7/16	3/16	⚡	⚡

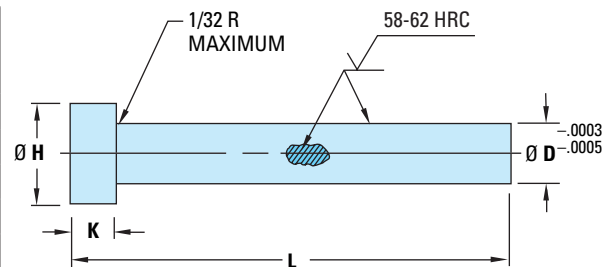

HOW TO ORDER: Create Item Number by adding L length in inches (06 or 10) after Item Number Prefix. Include zeros and dashes, as shown.

Examples: EJP-IMH-0062-06; EJP-IMH-0125-10; EJP-IMH-0250-10

⚡ Items in stock for immediate delivery

□ Contact D-M-E for quote

2" Shoulder Ejector Pins

ITEM NUMBER (WITH DIAMETER, LENGTH & SHOULDER LENGTH)	Ø D PIN BODY DIAMETER	L = 06 LENGTH (Inches)	S SHOULDER LENGTH
EJP-IMH-0062-06-200	1/16 (0.0625)	⚡	2.00
EJP-IMH-0078-06-200	5/64 (0.0781)	⚡	2.00
EJP-IMH-0093-06-200	3/32 (0.0937)	⚡	2.00

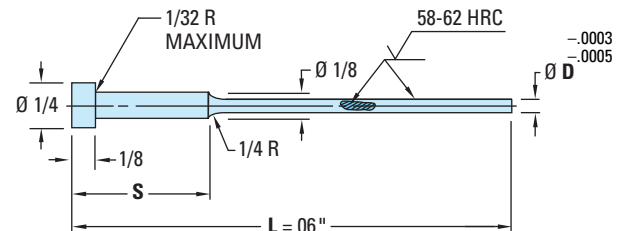

HOW TO ORDER: Specify Item Number including dashes, as shown.

Examples: EJP-IMH-0062-06-200; EJP-IMH-0093-06-200

All dimensions are specified in inches.



Every step of the way

World Headquarters

D-M-E Company
 29111 Stephenson Highway
 Madison Heights, MI 48071
 800-626-6653 toll-free tel
 248-398-6000 tel
 888-808-4363 toll-free fax
 www.dme.net web
 appl_eng@dme.net e-mail

D-M-E of Canada, Ltd.

6210 Northwest Drive
 Mississauga, Ontario
 Canada L4V 1J6
 800-387-6600 toll-free tel
 905-677-6370 tel
 800-461-9965 toll-free fax
 dme_canada@dme.net e-mail

D-M-E Europe C.V.B.A.

Industriepark Noord
 B-2800 Mechelen
 Belgium
 32-15-215011 tel
 32-15-218235 fax
 sales@dmeeu.com e-mail