

D-M-E Meteor™ Hot Runner Systems

CUSTOM-CONFIGURED,
ECONOMICAL SOLUTIONS
FOR QUICK DELIVERY



Meteor™ Hot Runner Systems

Table of Contents

<i>Overview</i>	94
<i>The Meteor Package</i>	95
<i>Ancillary Components</i>	95
<i>Nozzle Options</i>	95
<i>Application Notes</i>	95
<i>Meteor 1 In-Line and X-Style Manifolds</i>	96-97
<i>Meteor 1 & 2 Ancillary Component Options</i>	98-99
<i>Meteor 3 In-Line End Exit</i>	100
<i>Meteor 3 In-Line Center Exit</i>	101
<i>Meteor 3 X-Style</i>	102
<i>Meteor 3 Dimensional Information</i>	103-104
<i>Meteor 3 Reference Information</i>	105-106

More Solutions. More Choices. Always Quick Delivery.



Meteor 1 hot runner systems available for same-day shipment.

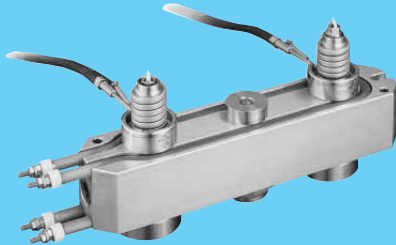

Meteor 2 manifold and components systems ship in one week or less.



Meteor 3 complete hot half assemblies ship in only three weeks. D-M-E mold base and temperature controller are optional.

The Meteor™ Manifold System provides a versatile yet economical solution for many hot runner mold designs. Two-drop (in-line) and four-drop (X-style) manifolds are available in sizes to suit a variety of applications. Pre-engineered with accurately machined flow channels, nozzle ports can be freely located anywhere within each manifold's flow channel limits. Stocked for quick delivery, Meteor manifolds are supplied with replaceable, press-fit tubular heaters. A full complement of ancillary components are also available to complete the system design and construction. Nozzle selection can be made from a broad array of D-M-E nozzles, including the 250 and 375 Series, the popular Mini Gate-Mate™ and the Gate-Mate 4™ Series.

Advantages

- Three levels of quick-delivery hot runner systems
- In-line and X-style manifolds for 2- and 4-drop applications
- Suitable for engineered and commodity resins
- Cost-effective
- Satisfaction 100% guaranteed

Choose the Meteor™ System that's right for you

D-M-E offers three quick-delivery hot runner systems with varying levels of customization – you pick the one that fits your needs.

Meteor 1

- Standard, off-the-shelf manifolds with machined horizontal flow channel
- Customer machines vertical flow channel locations and end plugs for maximum configuration flexibility
- Customer can easily order a Meteor 1 manifold kit and select nozzles, supports, nozzle seat, locating ring, thermocouples and other necessary items – for same-day shipment

Meteor 2

- Manifold and components system, integrated with a Meteor 1 manifold kit
- Customer specifies nozzles, supports, nozzle seat, locating ring, thermocouples, etc.
- D-M-E performs vertical flow channel and end plug machining
- Shipment in just one week (or less)

Meteor 3

- Complete hot-half assembly, ready to bolt onto the mold
- Turnkey solution with optional D-M-E mold base and 5-zone or 8-zone temperature controller
- Hot half fully assembled, wired and tested
- Industry-leading three-week delivery time

More Solutions. More Choices. Always Quick Delivery.

The Meteor Package

Each Meteor manifold kit includes the following standard items:

- Manifold with pre-machined horizontal flow channel
- Pre-installed, replaceable tubular heaters
- End plugs
- End plug set screws

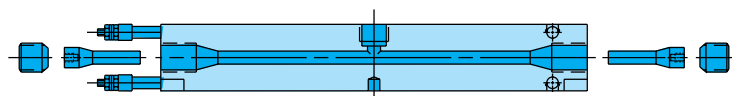

Ancillary Components

A variety of ancillary components available include:

- Locating rings
- Drool rings
- Nozzle seats
- Riser pads and cap screws
- Center support pads and dowel pins
- Thermocouples

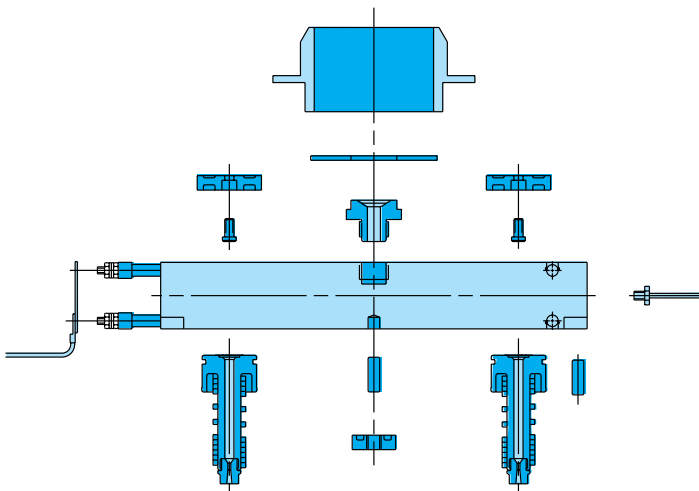

Nozzle Options

All nozzles have a selection of tip styles to suit material flow and gate cosmetic requirements.

METEOR SYSTEM	EHA AND CIA		MINI GATE-MATE	GATE-MATE 4 SERIES
	250 SERIES	375 SERIES		
METEOR 1	✓	✓	✓	✓
METEOR 2	✓	✓	✓	✓
METEOR 3	✓	✓	—	✓

Application Notes

- Mini Gate-Mate, Gate-Mate 4 and 250 Series nozzles to be used with manifold kits MEM0100K thru MEM0200K, MCM0100K thru MCM0200K and MXM0100K thru MXM0200K. Gate-Mate 4 and 375 Series nozzles to be used with all other manifold kits.
- All manifolds with suffix of 100K, 150K and 200K have a 9mm diameter flow channel; all other manifolds have a 12mm diameter flow channel.
- CIA High Performance nozzles are recommended for materials that process above 260°C/500°F.
- For filled or abrasive materials, wear-resistant tips are recommended.
- Meteor manifolds are not recommended for use with PVC material.

Contact D-M-E for assistance.



Meteor 1 In-Line and X-Style Manifolds

Meteor 1: Same-day shipment!

Meteor 1 In-Line End Exit

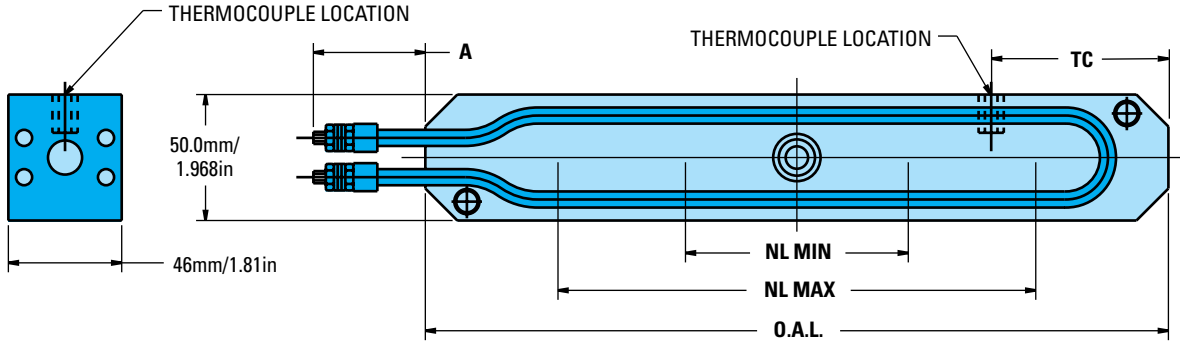

Meteor 1 In-Line Center Exit

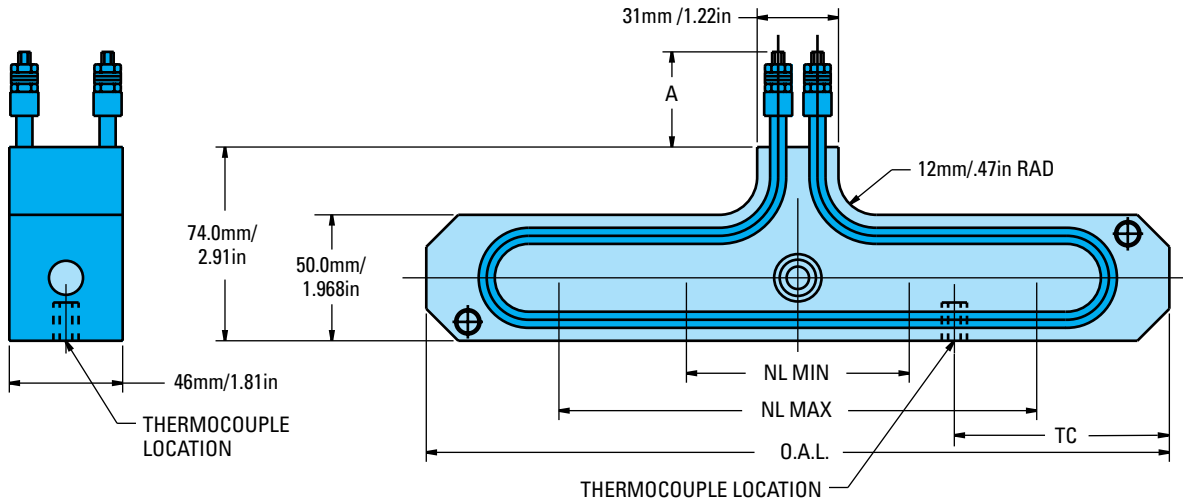

MANIFOLD TYPE	MANIFOLD KIT ITEM NO.	NL MIN.		NL MAX.		O.A.L.		A		B		TC	
		MM	INCH	MM	INCH	MM	INCH	MM	INCH	MM	INCH	MM	INCH
IN-LINE END EXIT	MEM0100K	55	2.165	100	3.937	195	7.677	44.5	1.75	—	—	60	2.362
	MEM0150K	100	3.937	150	5.906	245	9.646	44.5	1.75	—	—		
	MEM0200K	150	5.906	200	7.874	295	11.614	44.5	1.75	—	—		
	MEM0300K	200	7.874	300	11.811	395	15.551	44.5	1.75	—	—	72.5	2.362
	MEM0400K	300	11.811	400	15.748	495	19.488	50.8	2.00	—	—		
IN-LINE CENTER EXIT	MEM0500K	400	15.748	500	19.685	595	23.425	50.8	2.00	—	—	60	2.362
	MCM0100K	55	2.165	100	3.937	195	7.677	44.5	1.75	—	—		
	MCM0150K	100	3.937	150	5.906	245	9.646	44.5	1.75	—	—		
	MCM0200K	150	5.906	200	7.874	295	11.614	44.5	1.75	—	—	72.5	2.854
	MCM0300K	200	7.874	300	11.811	395	15.551	44.5	1.75	—	—		
X-STYLE	MCM0400K	300	11.811	400	15.748	495	19.488	50.8	2.00	—	—	SEE X-STYLE ^A	
	MCM0500K	400	15.748	500	19.685	595	23.425	50.8	2.00	—	—		
	MXM0100K	55	2.165	100	3.937	195	7.677	44.5	1.75	56.8	2.236		
	MXM0150K	100	3.937	150	5.906	245	9.646	44.5	1.75	51.3	2.020		
MXM0200K	150	5.906	200	7.874	295	11.614	50.8	2.00	51.3	2.020			
	MXCM0300K	200	7.874	300	11.811	395	15.551	50.8	2.00	51.3	2.020	72.5	2.854

Meteor 1 In-Line and X-Style Manifolds

Meteor 1 X-Style

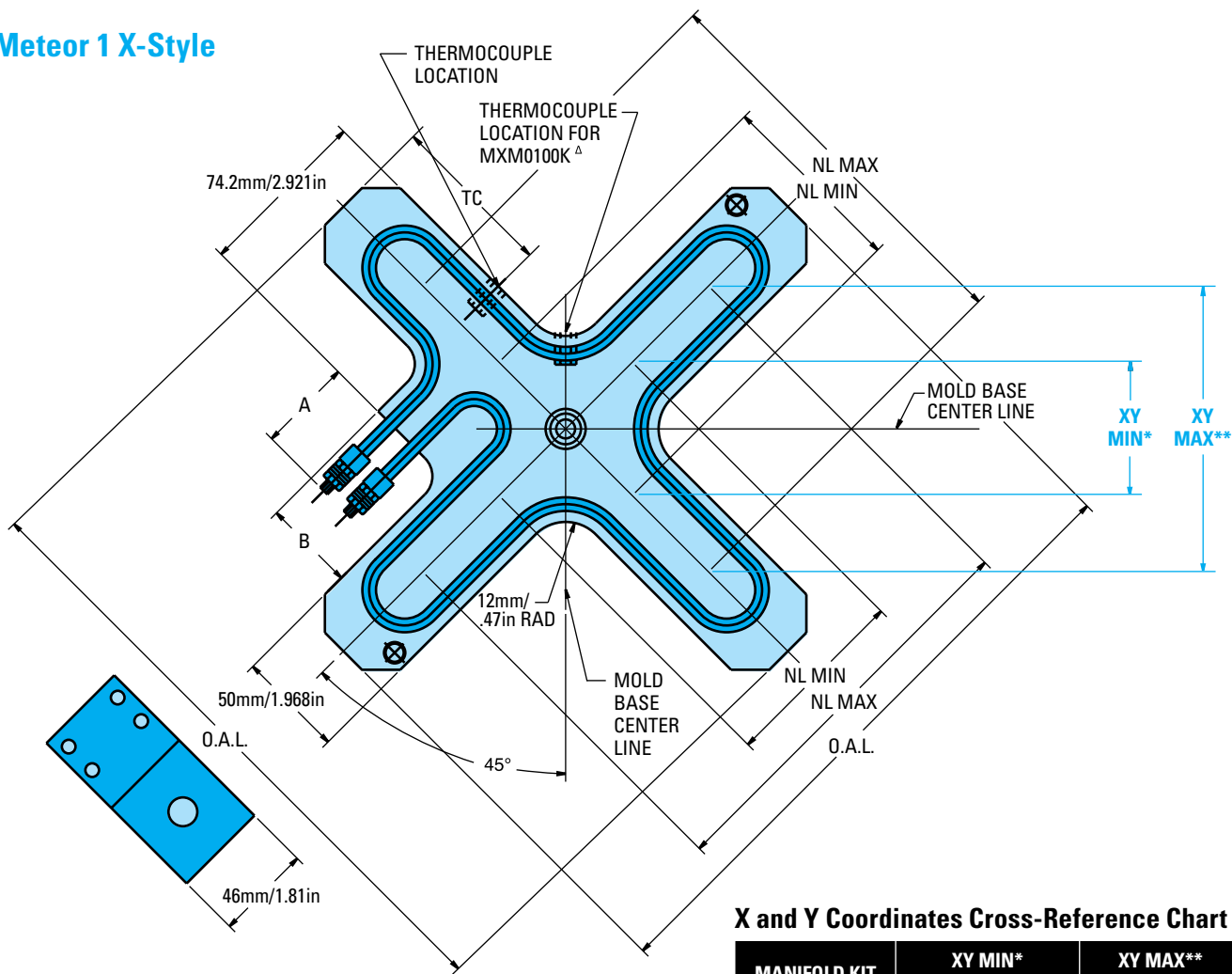

X and Y Coordinates Cross-Reference Chart

MANIFOLD KIT ITEM NO.	XY MIN*		XY MAX**	
	MM	INCH	MM	INCH
MXM0100K	38.90	1.531	70.71	2.783
MXM0150K	70.71	2.783	106.07	4.176
MXM0200K	106.07	4.176	141.42	5.568
MXM0300K	141.42	5.568	212.13	8.352

Meteor 1 Manifold Kit Includes:

In-Line System:

- (1) Manifold (center or end heater exit)
- (2) Tubular heaters (installed)
- (2) Tapered end plugs
- (2) Set screws

X-Style System:

- (1) Manifold
- (2) Tubular heaters (installed)
- (4) Tapered end plugs
- (4) Set screws

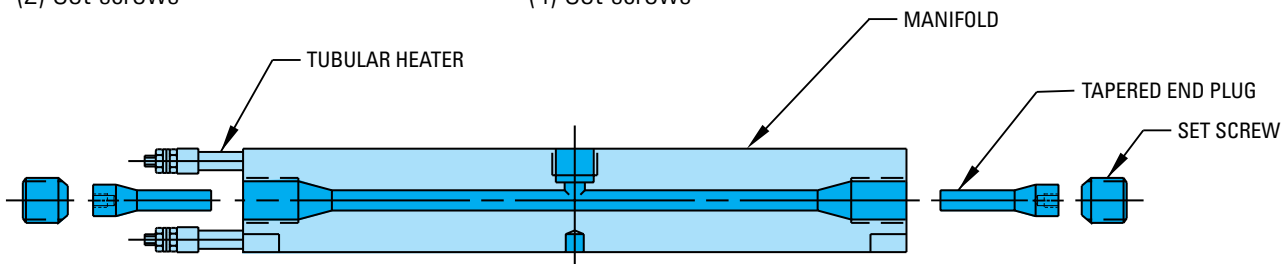

Meteor 1 & 2 Ancillary Component Options

Meteor 2: One-week delivery!

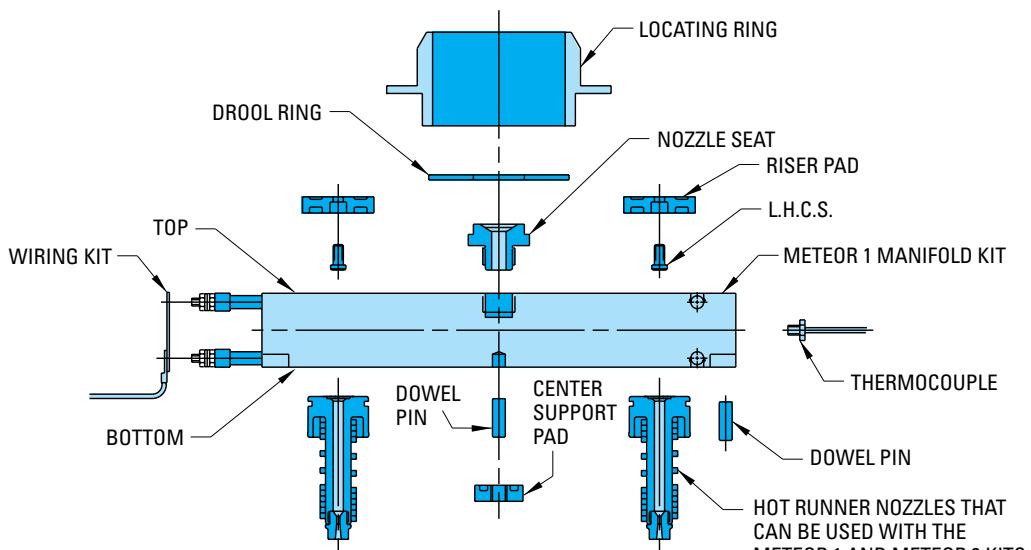

- HOT RUNNER NOZZLES THAT CAN BE USED WITH THE METEOR 1 AND METEOR 2 KITS:
- 250 SERIES EHA AND CIA
 - 375 SERIES EHA AND CIA
 - MINI GATE-MATE
 - GATE-MATE 4 SERIES

MANIFOLD TYPE	METEOR 1 MANIFOLD KIT ITEM NO.	METEOR 2 MANIFOLD KIT PLUS ITEM NO.	DESIGN CRITERIA	
			NOZZLE OPTIONS	V VERTICAL FLOW CHANNEL DIA. MM INCH
IN-LINE END EXIT	MEM0100K	MEM0100KP	250 SERIES EHA & CIA MINI GATE-MATE GATE-MATE 4 SERIES	9 .354
	MEM0150K	MEM0150KP		
	MEM0200K	MEM0200KP		
	MEM0300K	MEM0300KP	375 SERIES EHA & CIA GATE-MATE 4 SERIES	12 .472
	MEM0400K	MEM0400KP		
IN-LINE CENTER EXIT	MEM0500K	MEM0500KP		
	MCM0100K	MCM0100KP	250 SERIES EHA & CIA MINI GATE-MATE GATE-MATE 4 SERIES	9 .354
	MCM0150K	MCM0150KP		
	MCM0200K	MCM0200KP		
	MCM0300K	MCM0300KP	375 SERIES EHA & CIA GATE-MATE 4 SERIES	12 .472
X-STYLE	MCM0400K	MCM0400KP		
	MCM0500K	MCM0500KP		
	MXM0100K	MXM0100KP	250 SERIES EHA & CIA MINI GATE-MATE GATE-MATE 4 SERIES	9 .354
	MXM0150K	MXM0150KP		
	MXM0200K	MXM0200KP		
	MXM0300K	MXM0300KP	375 SERIES EHA & CIA GATE-MATE 4 SERIES	12 .472

Meteor 1 Manifold Kit includes manifold, tubular heaters installed, two end plugs, and two set screws. The customer machines the vertical flow channel locations and end plugs for maximum configuration flexibility.

Meteor 2 Manifold Kit Plus includes the machining of the vertical flow channels and the installation of the end plugs and set screws by D-M-E. The customer provides D-M-E with the gate locations on a Meteor 2 Criteria Form.

CUSTOMER DESIGN CRITERIA FORMS



To provide your Meteor™ application specifications, visit www.dme.net/cdc

MANIFOLD TYPE	METEOR 1 MANIFOLD KIT ITEM NO.	METEOR 2 MANIFOLD KIT PLUS ITEM NO.	ANCILLARY COMPONENT OPTIONS								
			THERMOCOUPLE ITEM NO.	LOCATING RING ITEM NO.	DROOL RING ITEM NO.	NOZZLE SEAT ITEM NO.	RISER PADS ITEM NO.	CTR. SUPPORT PADS ITEM NO.	DOWEL PINS ITEM NO.	1/4-20 X .50 LG. L.H.C.S. ITEM NO.	WIRING KIT ITEM NO.
IN-LINE END EXIT	MEM0100K	MEM0100KP	ETC0252	EHL0253 EHL0255 (1 REQ'D.)	EHL1003	MNS0009	ERP1001 ERP1002 ERP1011 ERP1012 (2 OF SAME REQ'D.)	ECB0468 ECB0469 ECB0503 (1 REQ'D.)	DP820 DP828 DP832 (2 OF SAME REQ'D.)	1412LH (2 REQ'D.)	MWK1001
	MEM0150K	MEM0150KP									
	MEM0200K	MEM0200KP									
	MEM0300K	MEM0300KP									
	MEM0400K	MEM0400KP									
	MEM0500K	MEM0500KP	ETC0252 (2 REQ'D.)			MNS0012					MWK1002
IN-LINE CENTER EXIT	MCM0100K	MCM0100KP	ETC0252	EHL0253 EHL0255 (1 REQ'D.)	EHL1003	MNS0009	ERP1001 ERP1002 ERP1011 ERP1012 (2 OF SAME REQ'D.)	ECB0468 ECB0469 ECB0503 (1 REQ'D.)	DP820 DP828 DP832 (2 OF SAME REQ'D.)	1412LH (2 REQ'D.)	MWK1001
	MCM0150K	MCM0150KP									
	MCM0200K	MCM0200KP									
	MCM0300K	MCM0300KP									
	MCM0400K	MCM0400KP									
	MCM0500K	MCM0500KP	ETC0252 (2 REQ'D.)			MNS0012					MWK1002
X-STYLE	MXM0100K	MXM0100KP	ETC0252	EHL0253 EHL0255 (1 REQ'D.)	EHL1003	MNS0009	ERP1001 ERP1002 ERP1011 ERP1012 (4 OF SAME REQ'D.)	ECB0468 ECB0469 ECB0503 (1 REQ'D.)	DP820 DP828 DP832 (2 OF SAME REQ'D.)	1412LH (2 REQ'D.)	MWK1001
	MXM0150K	MXM0150KP									
	MXM0200K	MXM0200KP									
	MXM0300K	MXM0300KP									

Meteor 1 & 2 Ancillary Component Options

Locating Rings

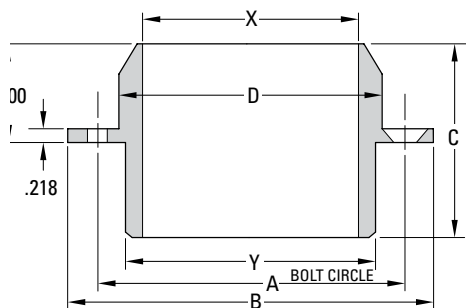

ITEM NO.	Ø D	Ø X	Ø Y	A	Ø B	C
EHL0253	101 MM 3.990 IN	82.5 MM 3.250 IN	95 MM 3.750 IN	117 MM 4.625 IN	139.5 MM 5.495 IN	73 MM 2.875 IN
EHL0255	101 MM 3.990 IN	82.5 MM 3.250 IN	95 MM 3.750 IN	117 MM 4.625 IN	139.5 MM 5.495 IN	114 MM 24.500 IN

Includes (2) 1/2 inch long, 5/16 Flat Head Cap Screws.

Machine Nozzle Seats

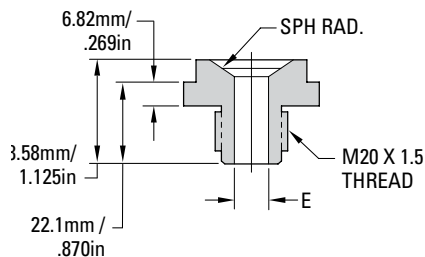

ITEM NO.	E FLOW CHANNEL		SPHERICAL RADIUS
	MM	IN	
MNS0009	9 MM	.354 IN	1/2 + 3/4 IN
MNS1009	9 MM	.354 IN	15.5 MM
MNS0012	12 MM	.472 IN	1/2 + 3/4 IN
MNS1012	12 MM	.472 IN	15.5 MM

NOTE: Machine nozzle tip orifice to be matched properly with nozzle seat flow channel.

Dowel Pins

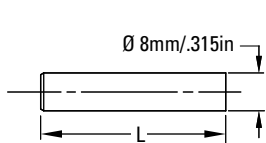

ITEM NO.	L	
	MM	IN
DP8-20	20	.787
DP8-28	28	1.102
DP8-32	32	1.260

Drool Ring

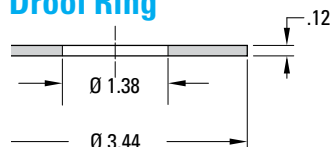

ITEM NO.
EHL1003

Center Support Pads

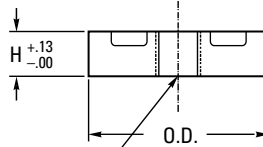
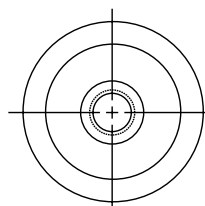

M10 X 1.5 THRU

ITEM NO.	O.D.		H	
	MM	IN	MM	IN
ECB0468	30	1.181	20	.787
ECB0469	30	1.181	10	.394
ECB0503	40	1.575	10	.394

NOTES:

1. The M10 X 1.5 tapped hole is used to screw the center support pad to a plate for machining the pad to the correct height.
2. An 8mm dia. dowel pin is required for assembly.

Manifold Thermocouple

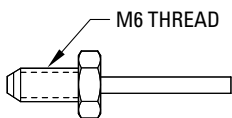

ITEM NO.
ETC0252

Riser Pads and Screws

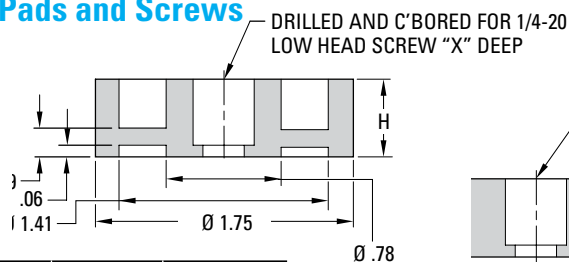

ITEM NO.	H		X	
	MM	IN	MM	IN
ERP1001	12.7	.500	10	.405
ERP1002	19	.750	16.6	.655

ITEM NO. 1412LH 1/4-20 x 1/2 lg. LOW HEAD CAP SCREW (L.H.C.S.)

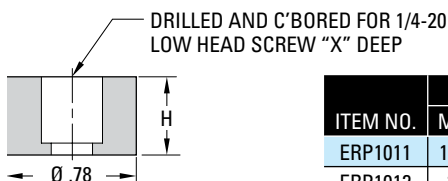

ITEM NO.	H		X	
	MM	IN	MM	IN
ERP1011	12.7	.500	10	.405
ERP1012	19	.750	16.6	.655

NOTE: For maximum support, use riser pads ERP1001 or ERP1002 whenever possible. Only use riser pads ERP1011 or ERP1012 when there are space constraints.

Meteor 3 In-Line End Exit

Meteor 3: Three-week delivery!

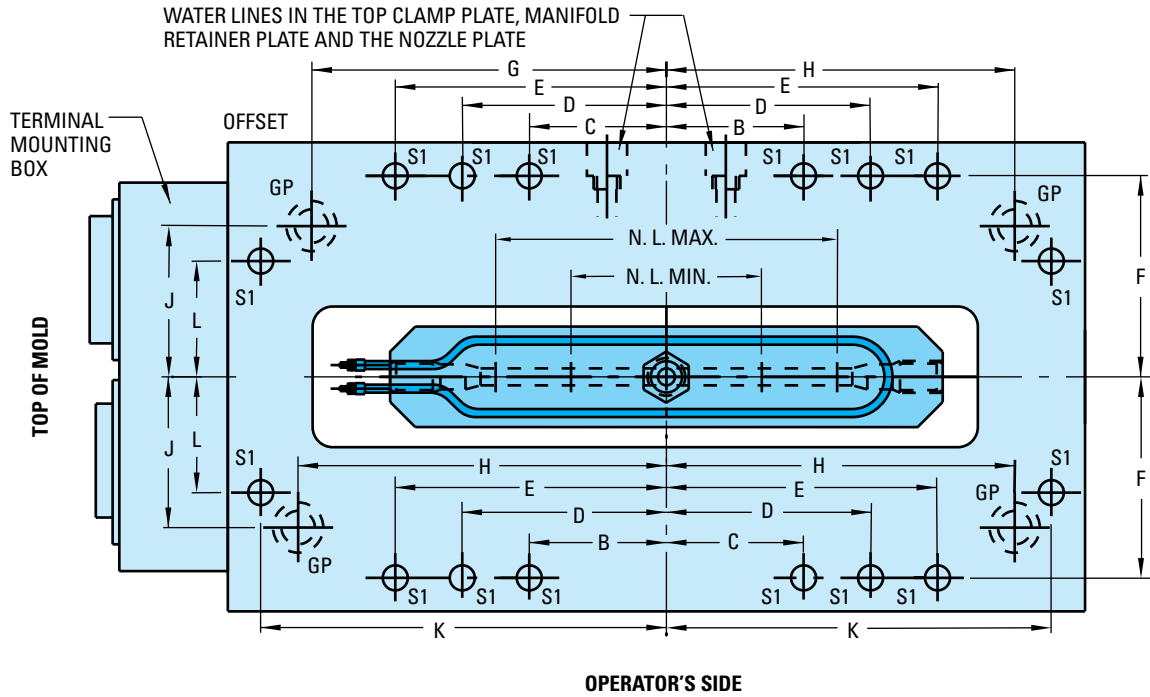

NOTE: The plan view is from mold locating ring/machine nozzle.

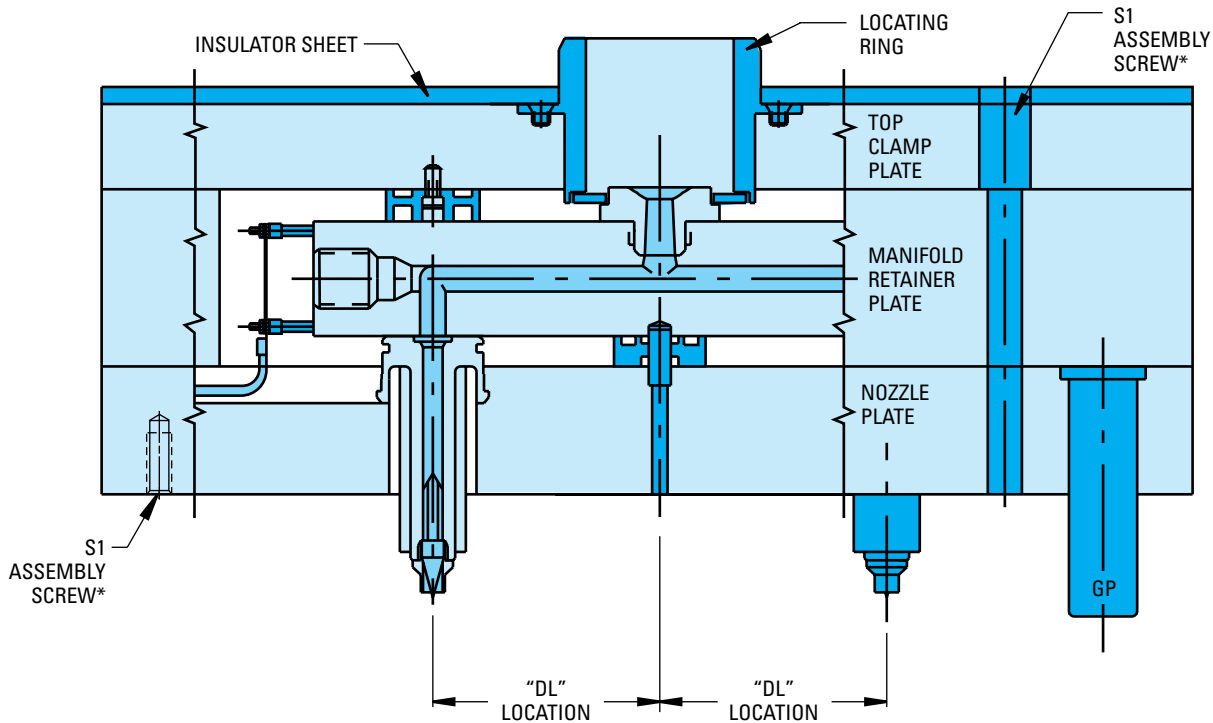

*S1 screws can be mounted either from the parting line or from the top clamp plate. Specify preference on criteria form when placing order.

Meteor 3 In-Line Center Exit

Meteor 3: Three-week delivery!

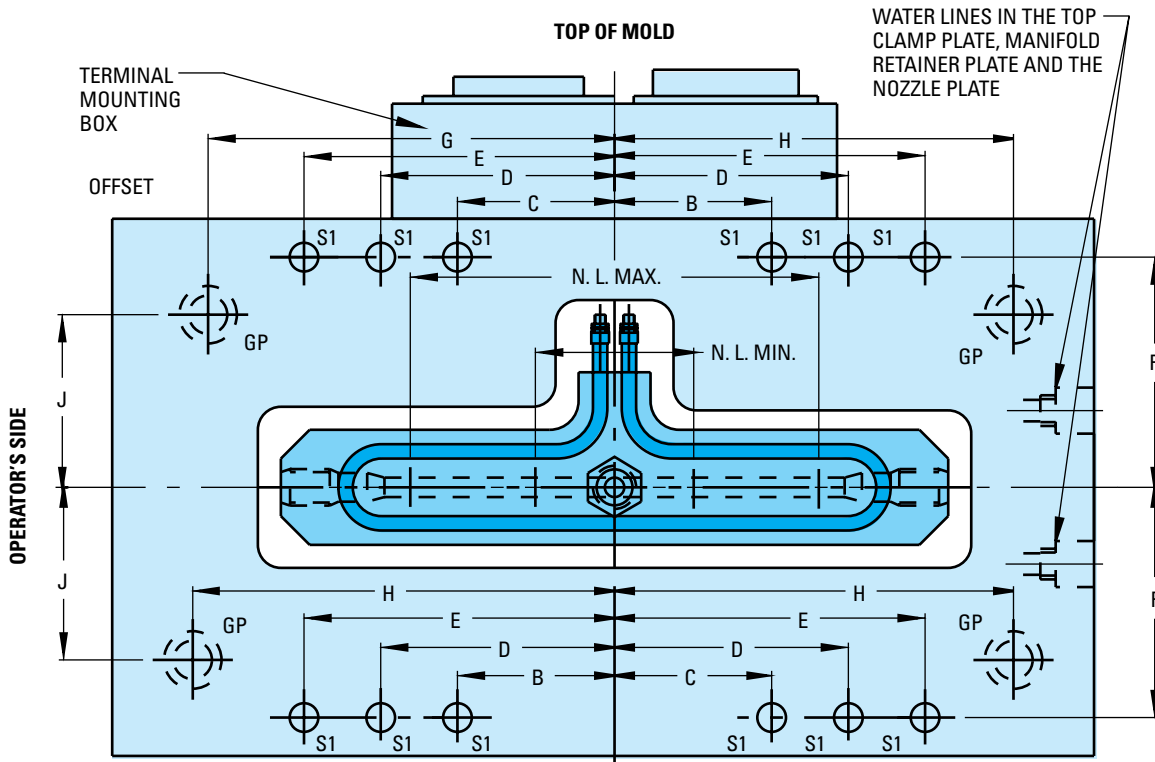

NOTE: The plan view is from mold locating ring/machine nozzle.

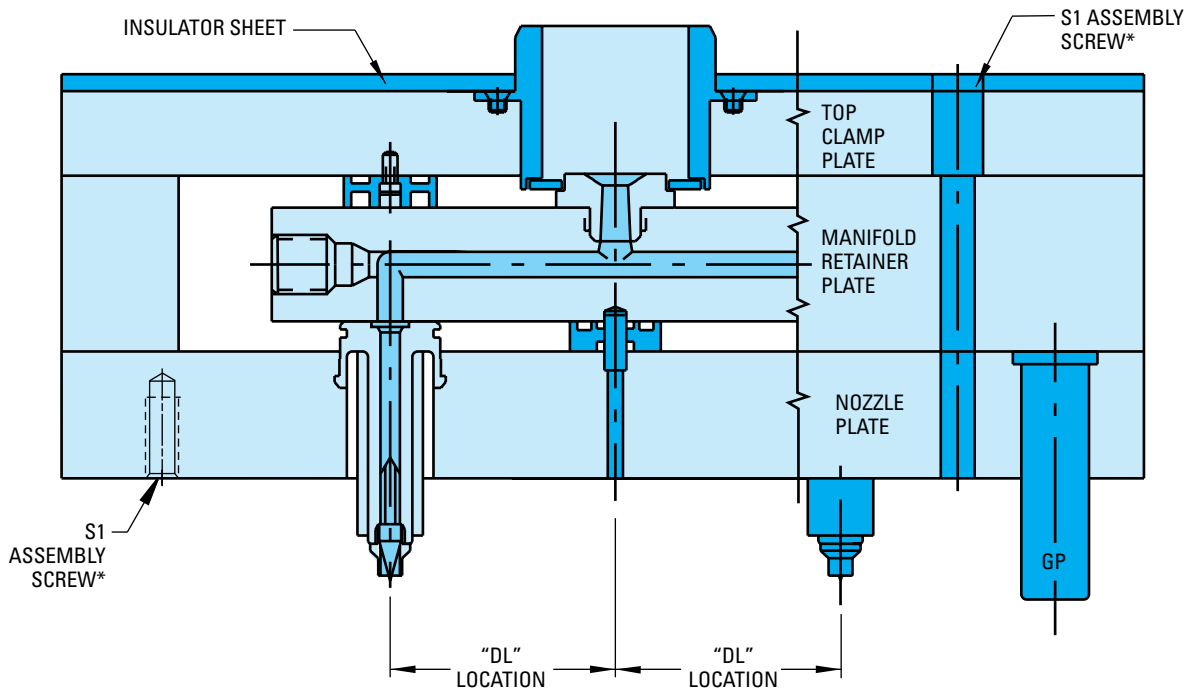

*S1 screws can be mounted either from the parting line or from the top clamp plate. Specify preference on criteria form when placing order.

Meteor 3 X-Style

Meteor 3: Three-week delivery!

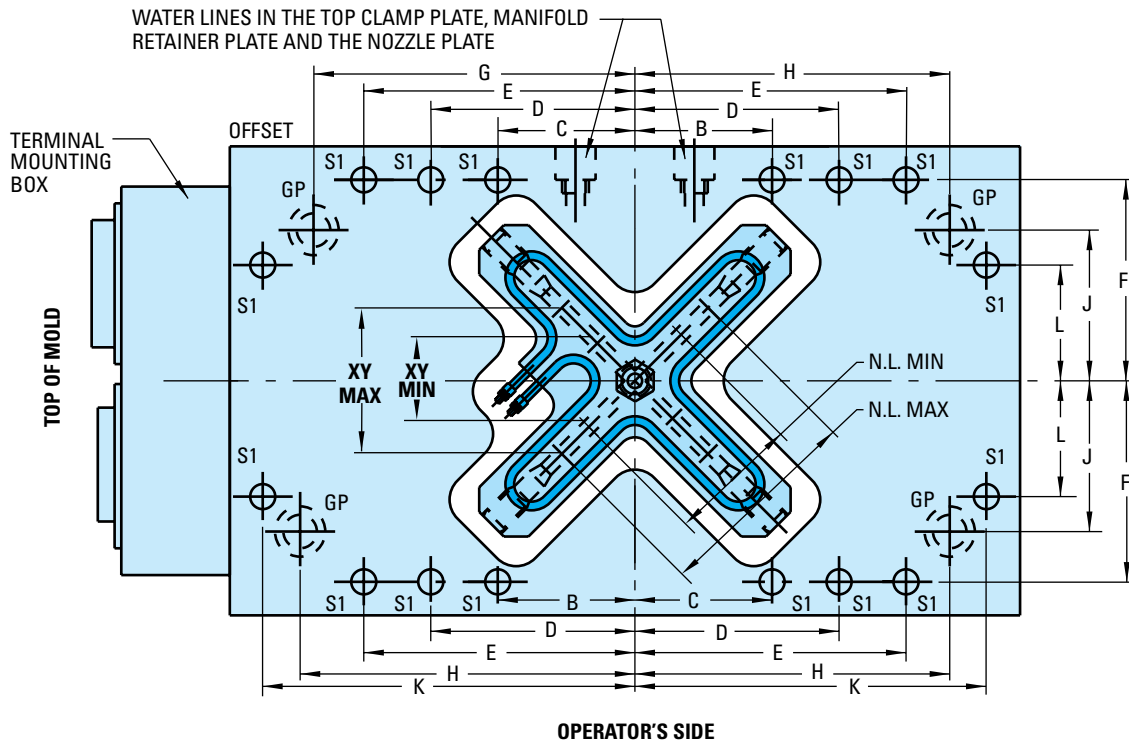

NOTE: The plan view is from mold locating ring/machine nozzle.

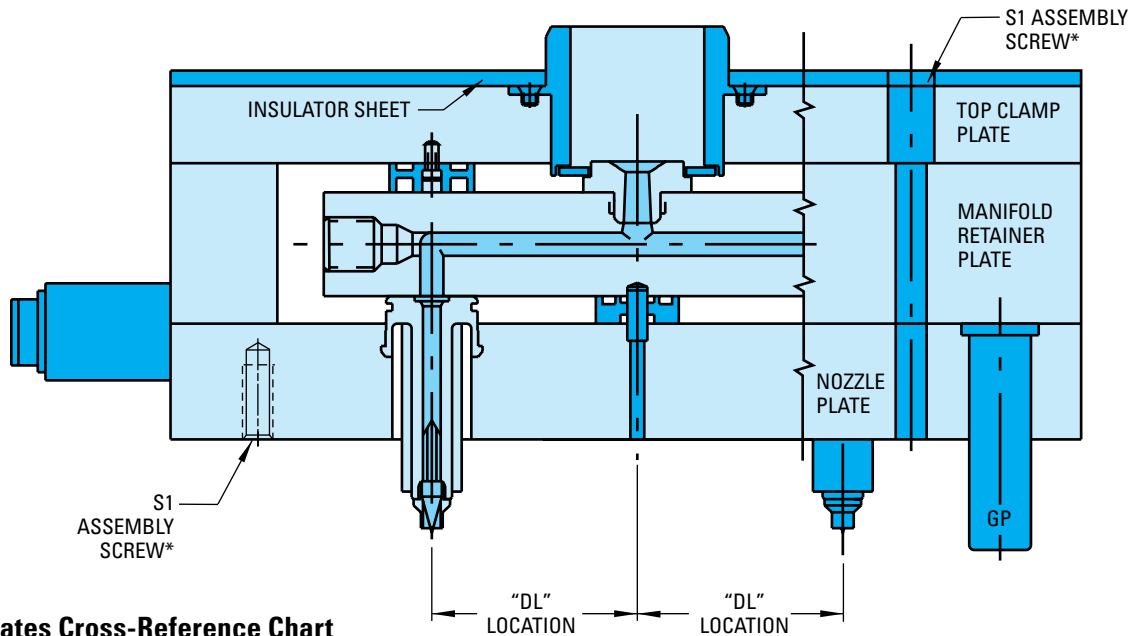

X and Y Coordinates Cross-Reference Chart

MANIFOLD KIT ITEM NO.	XY MIN*		XY MAX**	
	MM	INCH	MM	INCH
MXM0100K	38.90	1.531	70.71	2.783
MXM0150K	70.71	2.783	106.07	4.176
MXM0200K	106.07	4.176	141.42	5.568
MXM0300K	141.42	5.568	212.13	8.352

*S1 screws can be mounted either from the parting line or from the top clamp plate. Specify preference on criteria form when placing order.

NOTE: See In-Line and X-Style Manifolds for NL MIN and NL MAX.

Meteor 3 Dimensional Information In-Line End Exit and In-Line Center Exit

HOT HALF ASSEMBLY ITEM NUMBER		MOLD BASE SIZE	B	C	D	E	F	G	H	J	K	L
IN-LINE END EXIT	IN-LINE CENTER EXIT											
MEM0100KPH	MCM0100KPH	1215	—	1.000	—	5.375	4.969	5.4375	5.6250	3.8125	—	—
		1220	—	1.000	—	7.500	4.969	7.5625	7.7500	3.8125	—	—
		1315	—	1.000	—	5.375	5.719	5.4375	5.6250	4.5000	—	—
		1321	—	1.000	—	7.625	5.719	7.9375	8.1250	4.1875	—	—
		1620	—	1.000	—	7.125	6.969	7.5625	7.7500	5.0000	—	—
MEM0150KPH	MCM0150KPH	1220	—	1.000	—	7.500	4.969	7.5625	7.7500	3.8125	—	—
		1321	—	1.000	—	7.625	5.719	7.9375	8.1250	4.1875	—	—
		1620	—	1.000	—	7.125	6.969	7.5625	7.7500	5.0000	—	—
MEM0200KPH	MCM0200KPH	1321	—	1.000	—	7.6225	5.719	7.9375	8.1250	4.1875	—	—
		1524	3.625	3.625	—	8.625	6.469	8.4375	8.6250	5.0000	—	—
		1924	3.625	3.625	—	8.625	8.781	8.6875	8.8750	7.2500	—	—
MEM0300KPH	MCM0300KPH	1524	3.625	3.625	—	8.625	6.469	8.4375	8.6250	5.0000	—	—
		1924	3.625	3.625	—	8.625	8.781	8.6875	8.8750	7.2500	—	—
		1929	4.562	4.562	—	12.000	8.781	12.1875	12.3750	6.5000	—	—
MEM0400KPH	MCM0400KPH	1826	4.000	4.000	—	10.250	7.969	10.4375	10.6250	6.0000	—	—
		1929	4.562	4.562	—	12.000	8.781	12.1875	12.3750	6.5000	—	—
		2429	4.812	4.812	—	11.750	10.844	11.5625	11.7500	8.5000	13.750	6.750
MEM0500KPH	MCM0500KPH	2429	4.812	4.812	—	11.750	10.844	11.5625	11.7500	8.5000	13.750	6.750
		2435	3.875	3.875	9.625	14.750	10.844	14.6875	14.8750	8.5000	16.750	6.750

NOTE: "S1" screws for 24" wide mold bases are to be 5/8-11 S.H.C.S. All other mold bases require 1/2-13 S.H.C.S.

QDS Mold Bases Available for Meteor 3 – End Exit and Center Exit

HOT HALF ASSEMBLY (PREFIX)		SUITABLE D-M-E QDS MOLD BASES (SUFFIX)															
IN-LINE END EXIT	IN-LINE CENTER EXIT	1215	1220	1315	1321	1518	1524	1616	1620	1818	1820	1826	1924	1929	2424	2429	2435
MEM0100KPH	MCM0100KPH	✓	✓	✓	✓				✓								
MEM0150KPH	MCM0150KPH	N/A	✓	N/A	✓				✓								
MEM0200KPH	MCM0200KPH	N/A	N/A	N/A	✓	N/A	✓						✓				
MEM0300KPH	MCM0300KPH	N/A	N/A	N/A	N/A	N/A	✓						✓	✓			
MEM0400KPH	MCM0400KPH	N/A	N/A	N/A	N/A	N/A	N/A	N/A	N/A	N/A	N/A	✓	N/A	✓		✓	
MEM0500KPH	MCM0500KPH	N/A	N/A	N/A	N/A	N/A	N/A	N/A	N/A	N/A	N/A	N/A	N/A	N/A	N/A	✓	✓

NOTE: Program expansion ongoing. Contact D-M-E for delivery timeframes regarding availability of other mold base sizes.

Nozzle Options

D-M-E nozzles for use with Meteor 3 systems include:

- 250 Series EHA and CIA
- 375 Series EHA and CIA
- Gate-Mate 4 Series

All nozzles have a selection of tip styles to suit material flow and gate cosmetic requirements.

Meteor 3 Dimensional Information X-Style

MANIFOLD KIT PLUS ITEM NUMBER	MOLD BASE SIZE	B	C	D	E	F	G	H	J	K	L
MEM0150KPH	1220	—	1.000	—	7.500	4.969	7.5625	7.7500	3.8125	—	—
	1321	—	1.000	—	7.625	5.719	7.9375	8.1250	4.1875	—	—
	1620	—	1.000	—	7.125	6.969	7.5625	7.7500	5.0000	—	—
MEM0200KPH	1321	—	1.000	—	7.6225	5.719	7.9375	8.1250	4.1875	—	—
	1524	3.625	3.625	—	8.625	6.469	8.4375	8.6250	5.0000	—	—
	1924	3.625	3.625	—	8.625	8.781	8.6875	8.8750	7.2500	—	—
MEM0300KPH	1524	3.625	3.625	—	8.625	6.469	8.4375	8.6250	5.0000	—	—
	1924	3.625	3.625	—	8.625	8.781	8.6875	8.8750	7.2500	—	—
	1929	4.562	4.562	—	12.000	8.781	12.1875	12.3750	6.5000	—	—
MEM0400KPH	1826	4.000	4.000	—	10.250	7.969	10.4375	10.6250	6.0000	—	—
	1929	4.562	4.562	—	12.000	8.781	12.1875	12.3750	6.5000	—	—
	2429	4.812	4.812	—	11.750	10.844	11.5625	11.7500	8.5000	13.750	6.750

NOTE: "S1" screws for 24" wide mold bases are to be 5/8-11 S.H.C.S. All other mold bases require 1/2-13 S.H.C.S.

QDS Mold Bases Available for Meteor 3 – X-Style

HOT HALF ASSEMBLY (PREFIX)	SUITABLE D-M-E QDS MOLD BASES (SUFFIX)											
X-STYLE	1518	1524	1616	1620	1818	1820	1826	1924	1929	2424	2429	2435
MEM0100KPH	✓	N/A	✓	✓								
MEM0150KPH	✓	N/A	✓	✓								
MEM0200KPH	N/A	N/A	N/A	N/A	✓	✓		✓				
MEM0300KPH	N/A	N/A	N/A	N/A	N/A	N/A	N/A	N/A	N/A	✓	✓	✓

NOTE: Program expansion ongoing. Contact D-M-E for delivery timeframes regarding availability of other mold base sizes.

Nozzle Options

D-M-E nozzles for use with Meteor 3 systems include:

- 250 Series EHA and CIA
- 375 Series EHA and CIA
- Gate-Mate 4 Series

All nozzles have a selection of tip styles to suit material flow and gate cosmetic requirements.

Meteor 3 Reference Information and Item Numbers

Minimum Mold Plate Sizes

MANIFOLD TYPE	MANIFOLD KIT ITEM NO.	MINIMUM WIDTH		MINIMUM LENGTH	
		MM	INCH	MM	INCH
IN-LINE END EXIT	MEM0100K	302	11 7/8	381	15
	MEM0150K	302	11 7/8	508	20
	MEM0200K	302	11 7/8	527	20 3/4
	MEM0300K	302	11 7/8	610	24
	MEM0400K	302	11 7/8	660	26
	MEM0500K	302	11 7/8	737	29
IN-LINE CENTER EXIT	MCM0100K	302	11 7/8	381	15
	MCM0150K	302	11 7/8	508	20
	MCM0200K	302	11 7/8	527	20 3/4
	MCM0300K	302	11 7/8	660	24
	MCM0400K	302	11 7/8	749	26
	MCM0500K	302	11 7/8	902	29
X-STYLE	MXM0100K	378	14 7/8	406	16
	MXM0150K	378	14 7/8	406	16
	MXM0200K	454	17 7/8	457	18
	MXM0300K	603	23 3/4	603	23 3/4

Meteor Wiring Information

MANIFOLD TYPE	MANIFOLD KIT ITEM NO.	D-M-E CONTROLLER	WIRING LOCATION FOR NOZZLES AND MANIFOLD					
			ZONE 1	ZONE 2	ZONE 3	ZONE 4	ZONE 5	ZONE 6
IN-LINE END EXIT	MEM0100K	5 ZONE	NOZ. 1	NOZ. 2	MAN.	—	—	—
	MEM0150K		NOZ. 1	NOZ. 2	MAN.	—	—	—
	MEM0200K		NOZ. 1	NOZ. 2	MAN.	—	—	—
	MEM0300K		NOZ. 1	NOZ. 2	MAN.	—	—	—
	MEM0400K		NOZ. 1	NOZ. 2	MAN.	—	—	—
	MEM0500K		NOZ. 1	NOZ. 2	MAN. TOP	MAN. BTM.	—	—
IN-LINE CENTER EXIT	MCM0100K	5 ZONE	NOZ. 1	NOZ. 2	MAN.	—	—	—
	MCM0150K		NOZ. 1	NOZ. 2	MAN.	—	—	—
	MCM0200K		NOZ. 1	NOZ. 2	MAN.	—	—	—
	MCM0300K		NOZ. 1	NOZ. 2	MAN.	—	—	—
	MCM0400K		NOZ. 1	NOZ. 2	MAN.	—	—	—
	MCM0500K		NOZ. 1	NOZ. 2	MAN. TOP	MAN. BTM.	—	—
X-STYLE	MXM0100K	5 ZONE	NOZ. 1	NOZ. 2	NOZ. 3	NOZ. 4	MAN.	—
	MXM0150K		NOZ. 1	NOZ. 2	NOZ. 3	NOZ. 4	MAN.	—
	MXM0200K	8 ZONE	NOZ. 1	NOZ. 2	NOZ. 3	NOZ. 4	MAN. TOP	MAN. BTM.
			NOZ. 1	NOZ. 2	NOZ. 3	NOZ. 4	MAN. TOP	MAN. BTM.
			NOZ. 1	NOZ. 2	NOZ. 3	NOZ. 4	MAN. TOP	MAN. BTM.

Meteor Spare Parts

MANIFOLD TYPE	MANIFOLD KIT ITEM NO.	TUBULAR HEATER		END PLUG ITEM NO.	SET SCREW ITEM NO.
		ITEM NO.	WATTAGE		
IN-LINE END EXIT	MEM0100K	MEH0100	600	MTP0009	MSS0001
	MEM0150K	MEH0150	750		
	MEM0200K	MEH0200	900		
	MEM0300K	MEH0300	1225	MTP0012	
	MEM0400K	MEH0400	1550		
	MEM0500K	MEH0500	1850		
IN-LINE CENTER EXIT	MCM0100K	MCH0100	600	MTP0009	MSS0001
	MCM0150K	MCH0150	750		
	MCM0200K	MCH0200	900		
	MCM0300K	MCH0300	1225	MTP0012	
	MCM0400K	MCH0400	1550		
	MCM0500K	MCH0500	1850		
X-STYLE	MXM0100K	MXH0100	575	MTP0009	MSS0001
	MXM0150K	MXH0150	1350		
	MXM0200K	MXH0200	1675	MTP0012	
	MXM0300K	MXH0300	2150		

Tubular Heaters

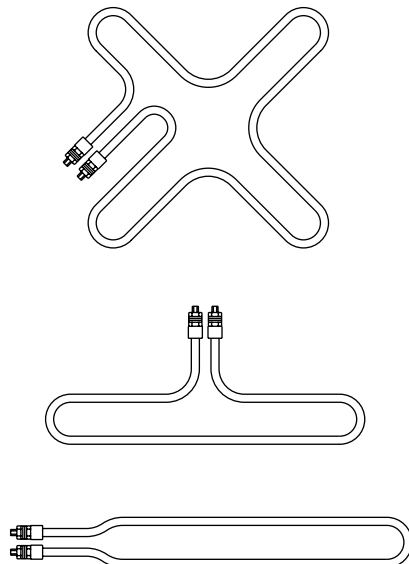

End Plugs

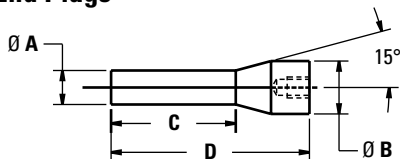

ITEM NO.	A		B		C		D	
	MM	INCH	MM	INCH	MM	INCH	MM	INCH
MTP0009	9	.354	14	.551	33	1.299	52.5	2.067
MTP0012	12	.472	16	.630	60	2.362	77.5	3.051

Set Screw



- Thread: M20 x 2.5
- Thickness: 20mm/.787in
- Hex Flat: 10mm/.394in

Meteor 3 Reference Information and Item Numbers

Meteor 3 Item Numbers

METEOR 3 TYPE	ITEM NUMBERS FOR HOT HALF ASSEMBLY	ITEM NUMBERS FOR HOT HALF ASSEMBLY AND MOLD BASE*	ITEM NUMBERS FOR HOT HALF ASSEMBLY, MOLD BASE AND TEMPERATURE CONTROLLER*
IN-LINE END EXIT	MEM0100KPH1215	MEM0100KPHM1215	MEM0100KPHM1215T
	MEM0100KPH1220	MEM0100KPHM1220	MEM0100KPHM1220T
	MEM0100KPH1315	MEM0100KPHM1315	MEM0100KPHM1315T
	MEM0100KPH1321	MEM0100KPHM1321	MEM0100KPHM1321T
	MEM0100KPH1620	MEM0100KPHM1620	MEM0100KPHM1620T
	MEM0150KPH1220	MEM0150KPHM1220	MEM0150KPHM1220T
	MEM0150KPH1321	MEM0150KPHM1321	MEM0150KPHM1321T
	MEM0150KPH1620	MEM0150KPHM1620	MEM0150KPHM1620T
	MEM0200KPH1321	MEM0200KPHM1321	MEM0200KPHM1321T
	MEM0200KPH1524	MEM0200KPHM1524	MEM0200KPHM1524T
	MEM0200KPH1924	MEM0200KPHM1924	MEM0200KPHM1924T
	MEM0300KPH1524	MEM0300KPHM1524	MEM0300KPHM1524T
	MEM0300KPH1924	MEM0300KPHM1924	MEM0300KPHM1924T
	MEM0300KPH1929	MEM0300KPHM1929	MEM0300KPHM1929T
	MEM0400KPH1826	MEM0400KPHM1826	MEM0400KPHM1826T
	MEM0400KPH1929	MEM0400KPHM1929	MEM0400KPHM1929T
	MEM0400KPH2429	MEM0400KPHM2429	MEM0400KPHM2429T
MEM0500KPH2435	MEM0500KPHM2435	MEM0500KPHM2435T	
IN-LINE CENTER EXIT	MCM0100KPH1215	MCM0100KPHM1215	MCM0100KPHM1215T
	MCM0100KPH1220	MCM0100KPHM1220	MCM0100KPHM1220T
	MCM0100KPH1315	MCM0100KPHM1315	MCM0100KPHM1315T
	MCM0100KPH1321	MCM0100KPHM1321	MCM0100KPHM1321T
	MCM0100KPH1620	MCM0100KPHM1620	MCM0100KPHM1620T
	MCM0150KPH1220	MCM0150KPHM1220	MCM0150KPHM1220T
	MCM0150KPH1321	MCM0150KPHM1321	MCM0150KPHM1321T
	MCM0150KPH1620	MCM0150KPHM1620	MCM0150KPHM1620T
	MCM0200KPH1321	MCM0200KPHM1321	MCM0200KPHM1321T
	MCM0200KPH1524	MCM0200KPHM1524	MCM0200KPHM1524T
	MCM0200KPH1924	MCM0200KPHM1924	MCM0200KPHM1924T
	MCM0300KPH1524	MCM0300KPHM1524	MCM0300KPHM1524T
	MCM0300KPH1924	MCM0300KPHM1924	MCM0300KPHM1924T
	MCM0300KPH1929	MCM0300KPHM1929	MCM0300KPHM1929T
	MCM0400KPH1826	MCM0400KPHM1826	MCM0400KPHM1826T
	MCM0400KPH1929	MCM0400KPHM1929	MCM0400KPHM1929T
	MCM0400KPH2429	MCM0400KPHM2429	MCM0400KPHM2429T
MCM0500KPH2429	MCM0500KPHM2429	MCM0500KPHM2429T	
MCM0500KPH2435	MCM0500KPHM2435	MCM0500KPHM2435T	
X-STYLE	MXM0100KPH1518	MXM0100KPHM1518	MXM0100KPHM1518T
	MXM0100KPH1616	MXM0100KPHM1616	MXM0100KPHM1616T
	MXM0100KPH1620	MXM0100KPHM1620	MXM0100KPHM1620T
	MXM0150KPH1518	MXM0150KPHM1518	MXM0150KPHM1518T
	MXM0150KPH1616	MXM0150KPHM1616	MXM0150KPHM1616T
	MXM0150KPH1620	MXM0150KPHM1620	MXM0150KPHM1620T
	MXM0200KPH1818	MXM0200KPHM1818	MXM0200KPHM1818T
	MXM0200KPH1820	MXM0200KPHM1820	MXM0200KPHM1820T
	MXM0200KPH1924	MXM0200KPHM1924	MXM0200KPHM1924T
	MXM0300KPH2424	MXM0300KPHM2424	MXM0300KPHM2424T
	MXM0300KPH2429	MXM0300KPHM2429	MXM0300KPHM2429T
	MXM0300KPH2435	MXM0300KPHM2435	MXM0300KPHM2435T

*Optional mold base and/or temperature controller are configured by customer.