

Clean-Flow® Drawer Magnets



Industrial Magnetics Inc.-IMI®

CONSTRUCTION:

- Ceramic 5
- Stainless Steel Magnetic Tubes, Located on 2" Vertical and Horizontal Centers
- Cast Ductile Iron Housings (Painted Black)
- 3/8" Polycarbonate Drawer Front
- Leak Proof Gasket



CFDM120C Shown with Posi-gate Shut-off

See the next page for pricing & options

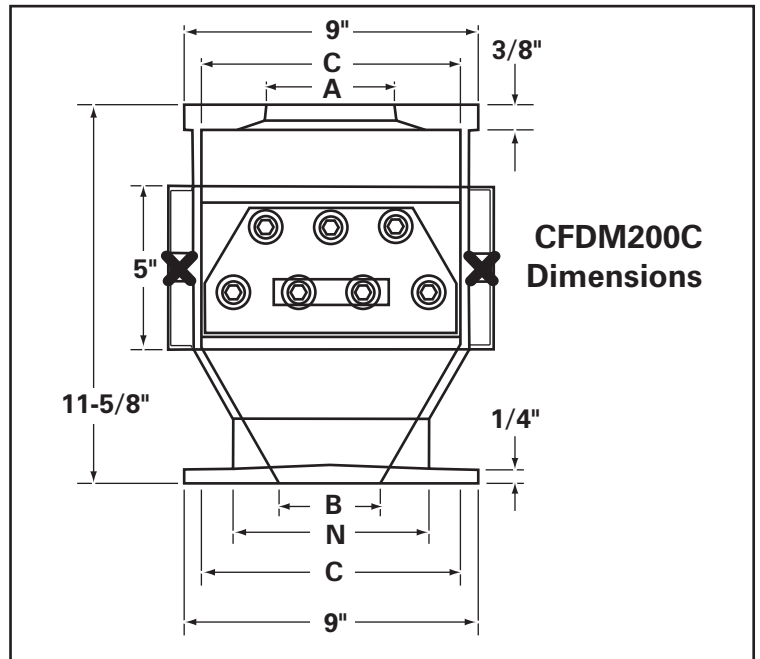
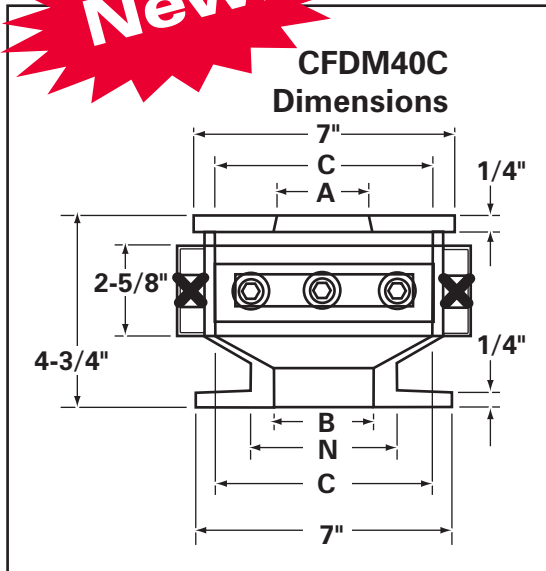
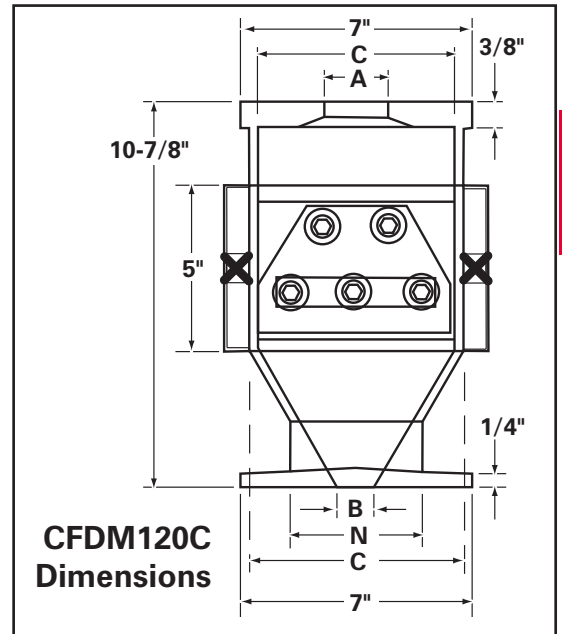

Specs.

Part No.	Round Inlet/Outlet		Square Inlet/Outlet				Hole Patterns C(L x W)		N.Neck O.D.	Capacity		# of Tubes	Approx. Weight		
	A(dia.) Min.	A(dia.) Max.	B(dia.) Min.	B(dia.) Max.	A(L x W) Min.	A(L x W) Max.	B(L x W) Min.	B(L x W) Max.		Cu. In.	Resin				
CFDM40C	2"	6 1/4"	2"	4 1/4"	2 x 2	6 1/4 x 6 1/4	2 x 2	3 x 3	4 x 4	6 x 6	4 3/4	71	40 oz.	3	22 Lbs.
CFDM40CS	2"	4 1/2"	2"	4 1/4"	2 x 2	4 1/2 x 4 1/2	2 x 2	*3 1/4 x 3 1/4	4 x 4	6 x 6	4 3/4	60	40 oz.	3	25 Lbs.
CFDM120C	3"	6 1/4"	2"	4 1/4"	3 x 3	6 1/4 x 6 1/4	2 x 2	3 x 3	4 x 4	6 x 6	4 3/4	284	120 oz.	5	35 Lbs.
CFDM120CS	3"	4 1/4"	2"	4 1/4"	3 x 3	4 1/4 x 4 1/4	2 x 2	*3 1/4 x 3 1/4	4 x 4	6 x 6	4 3/4	283	120 oz.	5	39 Lbs.
CFDM200C	4"	8 1/4"	3"	5 1/2"	4 x 4	8 1/4 x 8 1/4	3 x 3	4 x 4	5 x 5	8 x 8	6	490	200 oz.	7	50 Lbs.
CFDM200CS	4"	6 1/2"	3"	5 1/2"	4 x 4	6 1/2 x 6 1/2	3 x 3	*4 1/4 x 4 1/4	5 x 5	8 x 8	6	488	200 oz.	7	54 Lbs.

*Square inlets and outlets on units equipped with posi-gate shut-offs have a 1/2" machined radius in the corners. Note: Top and bottom plate extensions must be added for larger bolt hole patterns. Bottom plate adapters may be used for smaller bolt hole patterns. Flanges can be machined to custom sizes or shapes.

featuring the best of:

37

Clean-Flow® Drawer Magnets

OPTIONS:

1. Posi-Gate Shut Off
2. Accessory Port
3. Dump Tube (Std. on back)
4. Purging Spout (Mounted - Left or Right)
5. Automated Self-Cleaning
6. Manual EZ-Clean
7. Nickel Plated Interiors
8. Stainless Steel Drawer Front
9. 1/2" Thick Extended Top Plate
10. 1/2" Thick Extended Bottom Plate
11. UHI-50™ (Rare Earth) Circuit Designs
12. Special Paint Colors

REFER TO DRAWING AND PRICING BELOW

CALL FOR PRICING

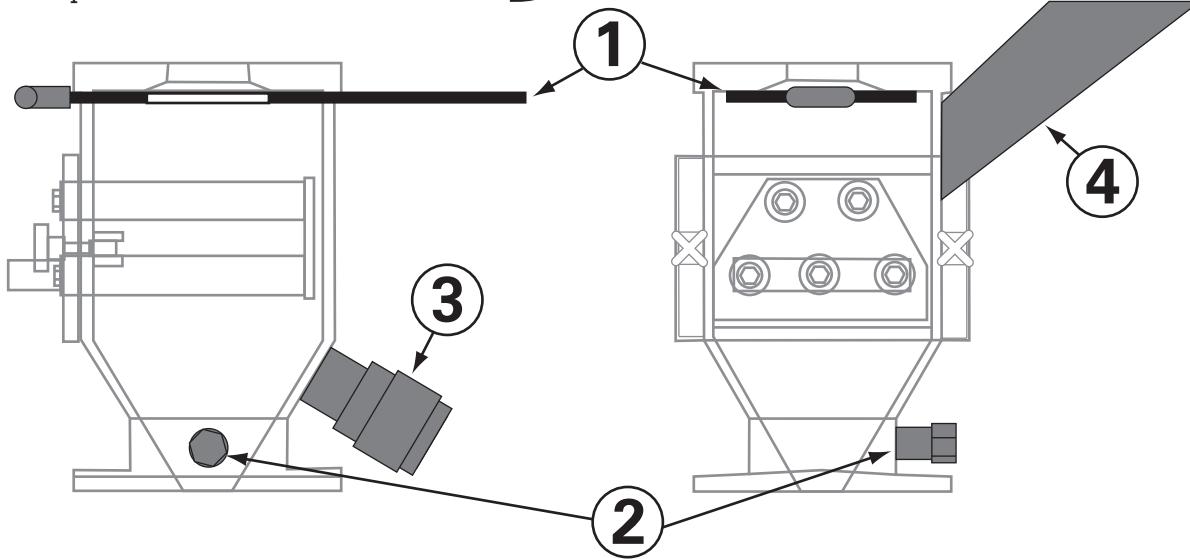

Pricing (Standard- no bolt holes)	
Part No.	Price
CFDM40C	\$317.14
CFDM40CS*	\$365.71
CFDM120C	\$421.43
CFDM120CS*	\$462.86
CFDM200C	\$604.29
CFDM200CS*	\$621.43

Pricing (Unique- Customer Supplied Bolt Pattern)	
Part No.	Price
CFDM40CB	\$317.14
CFDM40CSB*	\$365.71
CFDM120CB	\$438.57
CFDM120CSB*	\$491.43
CFDM200CB	\$564.29
CFDM200CSB*	\$637.14

***NOTE:**
Optional Posi-Gate Shut-off available!
(refer to option#1 and corresponding drawing above)

Options	
Part No.	Price
DUMP TUBE	\$22.86
PURGING SPOUT	\$82.86
LIQUID PORT	\$22.86



Resin Drain Slide Magnet Accessories



For Customers Buying Clean-Flows™

Resin Drain Slide Mounted on Machine

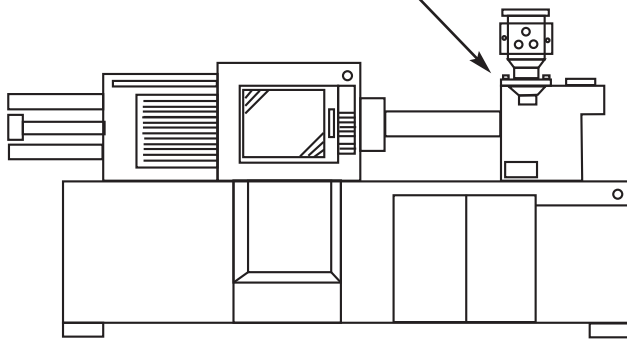

FEATURES:

- 1" thick aluminum plate
- Large drain hole
- UHMW sliding surface
- Lock screw
- Adjustable slide tension

BENEFITS:

- Stable secure base
- Extremely fast material change over
- No metal to metal wear
- No tools required



Part No.	Length A	Width B	Weight	Price
RDS120*	16-1/2"	8"	12.00 lbs	\$864.29
RDS200	20"	10"	16.50 lbs	\$891.43

***Note:** For CFDM40C Clean-Flow use resin drain slide part number RDS120. Overall width "B" dimension may vary due to mounting requirements of the machine

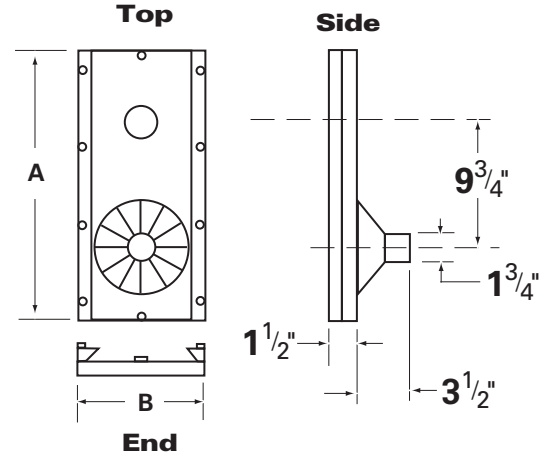

MACHINE SURFACE MOUNTING REQUIREMENTS:

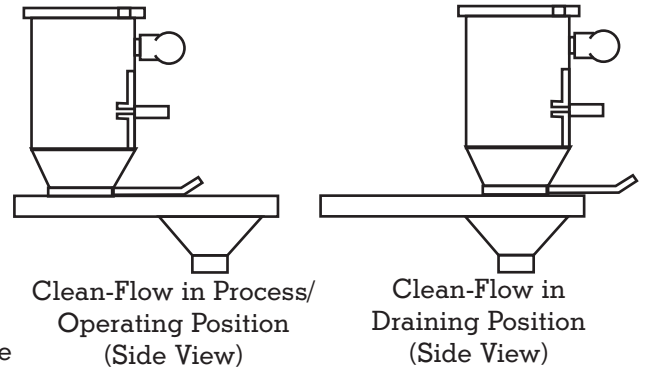
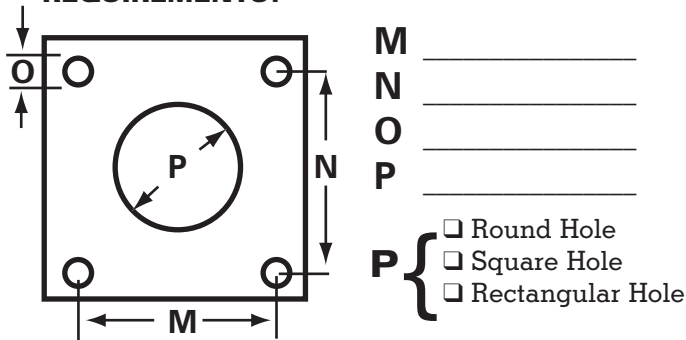

For Customers Using Existing Magnet Housings or Hoppers

A slide plate is provided as a mounting surface for existing auxiliary equipment. The slider plate is used to slide auxiliary equipment to the large drain hole for quick material change over. Part numbers for Resin Drain Slide with a slide plate is designated by adding a "P" to the end of the Part Number. Example: RDS29P.

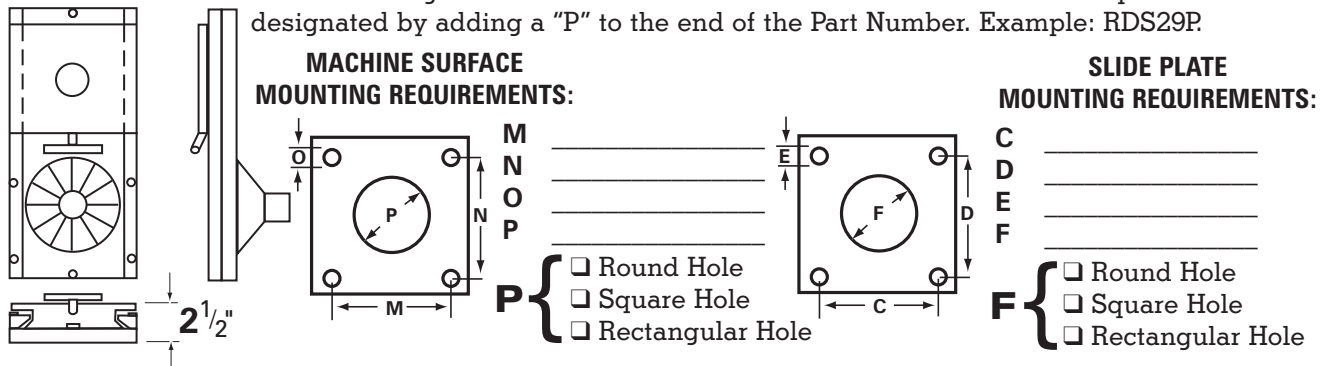

featuring the best of:

INTRODUCTION:

Our JIT ("Just-In-Time") Clean Flow drawer magnet is ideal for closed-loop Just-In-Time systems. This compact unit was designed to provide maximum tramp metal protection for low volume injection molding operations. The two powerful Rare Earth tubes that come standard in our JIT Clean Flow offer twice as much protection as similar units that only come with a single tube.

The JIT Clean Flow offers a versatile flange design that allows for multiple mounting as well as inlet and outlet opening options to meet the requirements of your application. Once mounted on your plastic molding machine, the clear polycarbonate door allows you to monitor resin flow and see any tramp metal collected on the tubes. The door features a custom gasket and spring loaded knobs for easy tube cleaning and leak-free operation.

The durable, cast aluminum housing features a smooth vibratory finish, which in addition to steep interior wall angles, prevents resin build-up by eliminating any texture where resin can adhere. The lightweight housing has a maximum resin capacity range of 18oz. Inlet and outlet sizes are custom machined to your specifications. The top and bottom flanges are also drilled and/or tapped to your mounting specifications. Please fill out the worksheet on the next page to ensure proper mounting hole, inlet and outlet opening sizing and location.

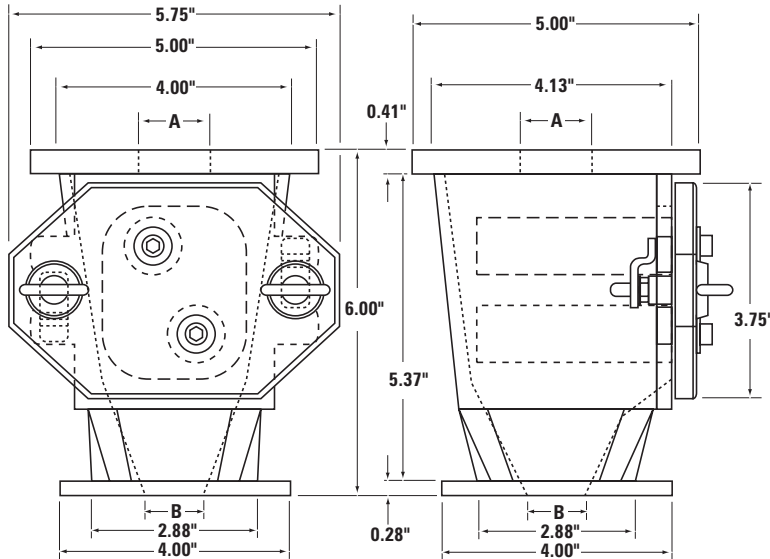
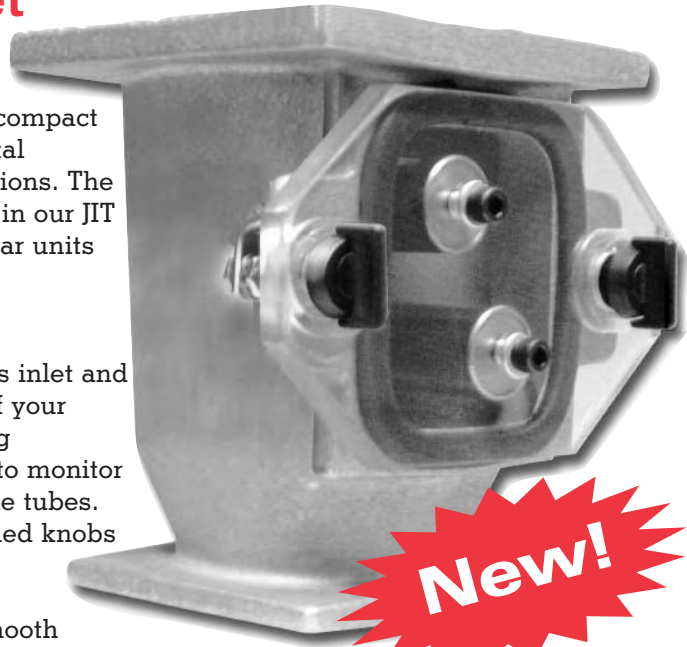

FEATURES:

- 2 offset Rare Earth magnetic tubes (ceramic tubes also available) force the product flow to cascade, ensuring direct and repeated contact with the magnets.
- Steep interior wall angles ensure optimum flow and efficiency.
- Maximum capacity of 18 oz. eliminates material condensation and clogging.
- Lightweight aluminum housing.
- Custom inlets, outlets and mounting patterns to match your JIT system.
- 3/8" thick polycarbonate door for convenient flow monitoring.
- "Quarter-Turn" spring-loaded door latch system creates a positive seal, making removal and replacement of the drawer for cleaning fast and simple.

DIMENSIONS:

A = Inlet Opening:

Round = 1" Min. Dia, 3.5" Max. Dia.
Square = 1" x 1" Min., 2.5" x 2.5" Max.,
with 1/4" radius corners.

B = Outlet Opening:

Round = 1" Min. Dia, 2.5" Max. Dia.
Square = 1" x 1" Min., 1.75" x 1.75" Max.,
with 1/4" radius corners.

Pricing (Standard- no bolt holes)	
Part No.	Price
CFJT18C	\$250.00
CFJT18CS*	\$397.14

Pricing (Unique- Customer Supplied Bolt Pattern)	
Part No.	Price
CFJT18CB	\$250.00
CFJT18CSB*	\$397.14

*NOTE:

Optional Posi-Gate Shut-off available!
featuring the best of:

Clean-Flow® Drawer Magnets

Application Specifications

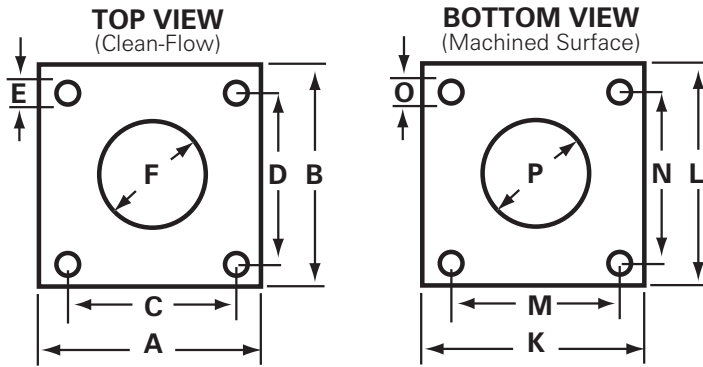

Part Number: _____

Ship To: _____

Bill To: _____



Standard Mounting Pattern Specifications:

- Interior bolt patterns will be tapped holes unless they interfere with shut-off gates, in which case studs will be used.
- Bolt patterns contacting the housing wall will be supplied with threaded studs to ensure proper sealing of the unit. If other mounting is required an adapter plate may be needed to accommodate the mounting pattern.
- All bolt patterns clearing the outside wall of the housing are supplied with customer specified through holes, tapped holes or studs.

Top Plate Dimensions:

A= _____ standard or
*extended to

B= _____ standard or
*extended to

C= _____

D= _____

E= _____

F= _____

Bottom Plate Dimensions:

K= _____ standard or
*extended to

L= _____ standard or
*extended to

M= _____

N= _____

O= _____

P= _____

- INLET:**
- F** { Round Hole
 Square Hole
 Rectangular Hole

- OUTLET:**
- P** { Round Hole
 Square Hole
 Rectangular Hole

10 working day lead time standard on all orders

NOTE:

*Non-standard top and bottom plate dimensions may result in additional charges. Mounting bolt size dimensions "E" is usually tapped. Dimension "O" is usually a through hole. Illustrate any non-uniform bolt and throat openings.

OPTIONS:

- | | | |
|---|---|---|
| <input type="checkbox"/> Posi-Gate Shut Off | <input type="checkbox"/> Automated Self-Cleaning | <input type="checkbox"/> Nickel Plated Interiors |
| <input type="checkbox"/> Purging Spout Left Side Mount | <input type="checkbox"/> Accessory Port | <input type="checkbox"/> Dump Tube (Standard on back) |
| <input type="checkbox"/> Purging Spout Right Side Mount | <input type="checkbox"/> 1/2" Thk Extended Top Plate | <input type="checkbox"/> Stainless Steel Drawer Front |
| <input type="checkbox"/> Quick Manual Cleaning | <input type="checkbox"/> 1/2" Thk Extended Bottom Plate | <input type="checkbox"/> Special Paint Colors |

COMMENTS:

featuring the best of:

Northern Supply (800-365-6565) • Nickerson Machinery (800-821-9534) • OHS (Ontario-888-809-7050/Quebec-888-475-9224)

Torpedo Magnets

Hopper Loader Magnet

INTRODUCTION:

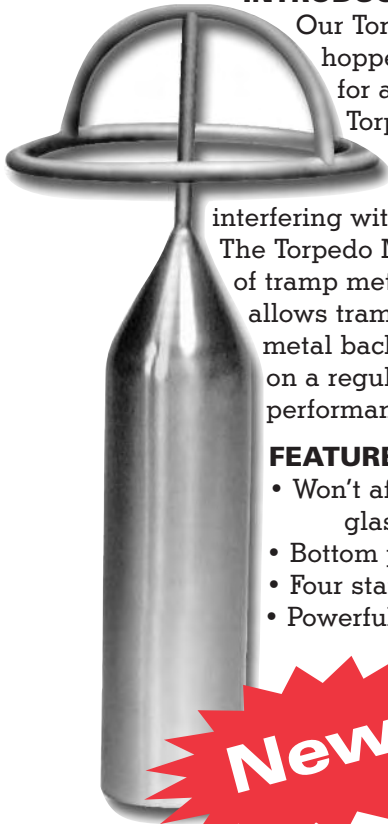

Our Torpedo Magnet is designed to capture tramp metal in Just-In-Time (JIT) hopper loaders. These powerful, compact 50 Mgoe Rare Earth magnets are ideal for applications where a Clean-Flow™ magnet won't fit in the JIT system. The Torpedo Magnet's cartridge hangs in the center of the hopper loader's glass tube from a stainless steel ring and handle. From this position, it prevents tramp metal from entering your plastic molding machine, without interfering with the flow of material from the hopper.

The Torpedo Magnet is visible through the JIT's glass tube for easy inspection of tramp metal build up. The magnetic pole located on the bottom of the cartridge allows tramp metal to collect in a protected area, preventing wash-off of the collected metal back into the product flow. Tramp metal should be cleaned from the magnet on a regular basis to ensure that build-up on the magnet doesn't affect its performance.

FEATURES:

- Won't affect material level sensors that are mounted on the outside of the JIT's glass tube
- Bottom pole is magnetized to prevent wash-off of collected metal
- Four standard sizes available to fit your application
- Powerful Rare Earth magnetic cartridge
 - Stainless steel, all welded construction

New!

SPECIFICATIONS:

- 9/16" diameter Torpedo Magnets are recommended for hopper loaders with glass tubes under 2-1/4" in diameter
- 1" diameter Torpedo Magnets are recommended for hopper loaders with glass tubes over 2-1/4" in diameter
- Always select a Torpedo Magnet with a ring diameter that is slightly larger than your hopper opening to ensure proper magnet location

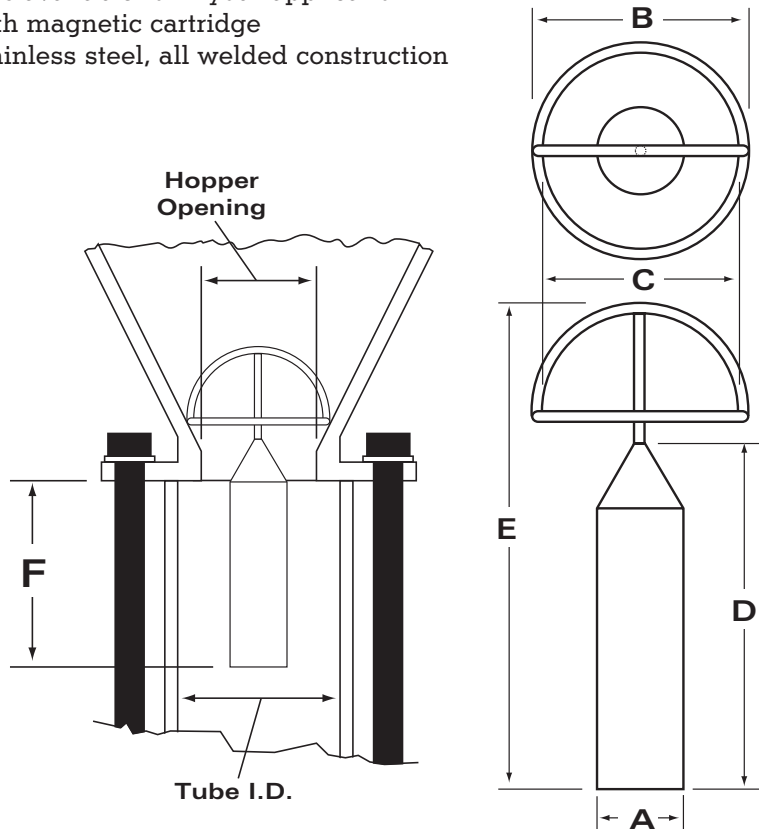

Part Number	Magnet Dia. (A)	Ring O.D. (B)	Ring I.D. (C)	Magnet Length (D)	Overall Length (E)	Approx. Depth (F)	Price Each
TPM562-178	9/16"	1 7/8"	1 5/8"	2 5/8"	4 7/32"	2 5/16"	\$107.14
TPM562-212	9/16"	2 1/2"	2 1/4"	2 5/8"	4 1/2"	2 5/16"	\$107.14
TPM1-178	1"	1 7/8"	1 5/8"	4"	5 9/16"	3 11/16"	\$151.43
TPM1-212	1"	2 1/2"	2 1/4"	4"	5 7/8"	3 11/16"	\$151.43

Vacuum 4JIT Magnet

Vacuum Line Magnet



A

FEATURES:

- Welded Stainless Steel Construction
- Powerful Rare Earth Magnetic Circuit
- Connecting ends are constructed of .065" wall thickness tubing

OPTIONS:

- Custom Sizes and Designs
- Ceramic or Alnico Magnetic Circuits

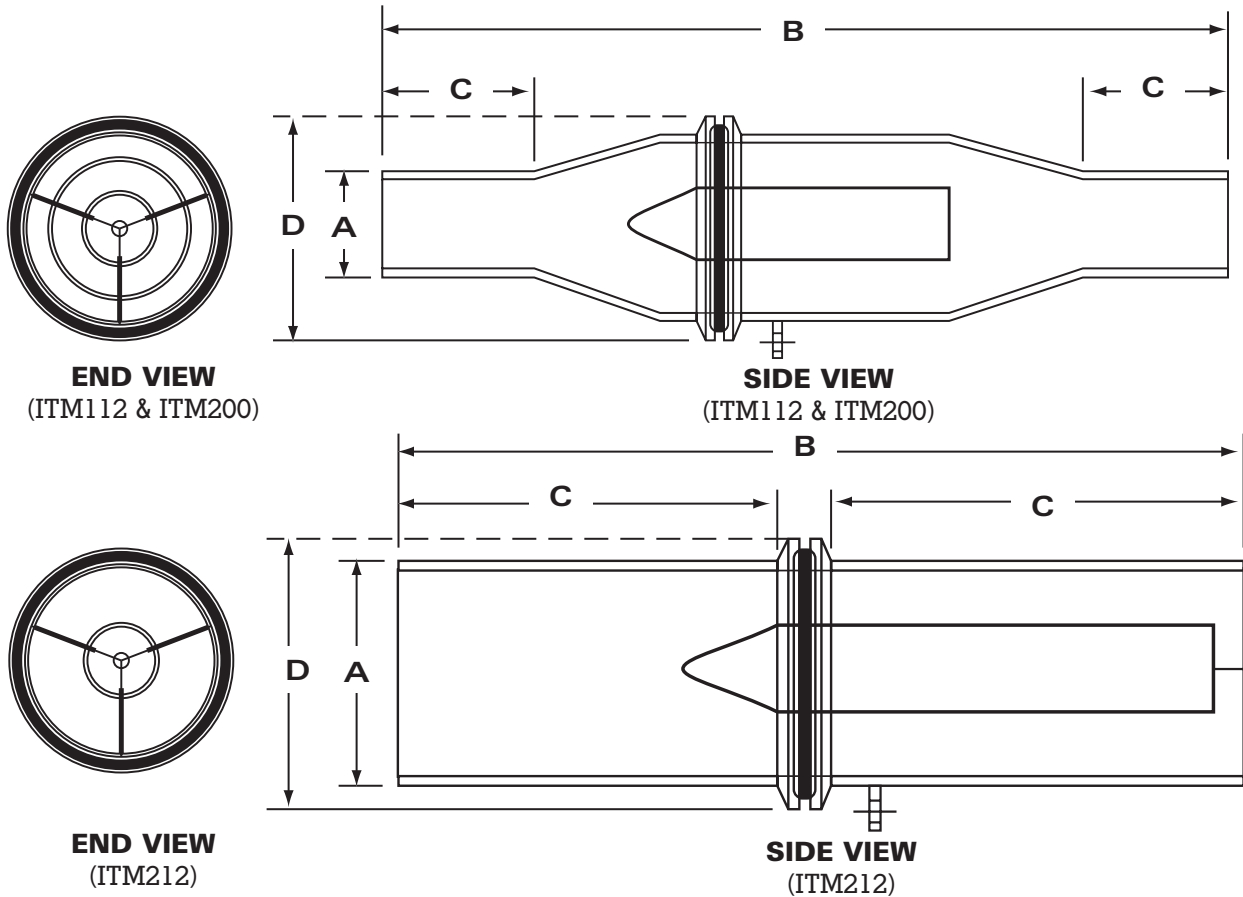

Part Number	Line Size A (O.D.)	Overall Length B	Connecting Ends C	Overall Dia. D	Weight lbs.	Price
ITM112	1-1/2"	12-1/8"	2-1/8"	2-1/8"	3.33	\$318.57
ITM200	2"	10-1/8"	2-1/16"	2-1/16"	3.00	\$342.86
ITM212	2-1/2"	6-3/4"	2-13/16"	2-13/16"	2.50	\$415.71

featuring the best of:

Northern Supply (800-365-6565) • Nickerson Machinery (800-821-9534) • OHS (Ontario-888-809-7050/Quebec-888-475-9224)

Hopper Grate Magnets

DIVERTER STYLE OPTIONS ON ALL MAGNETS

(Price is the same no matter what option you choose)

"A" = (Default Config.)

The popular 90° angle gives optimum direction of material to the magnet. Ideal for capturing fines.

Peak is 1-5/8" (4.127cm) from the center of the magnet.

"B" = Ideal for medium or soft materials, 60° angle allows material to flow freely but doesn't force as much material contact with the magnet.

"C" = For coarse materials with minimum flow restriction. 3/8" (.9525cm) dia. stainless rod.

"N" = No Diverters

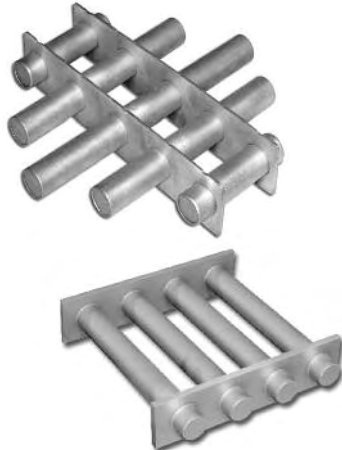
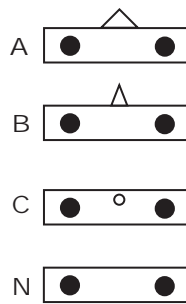

*Example: A 4" dia. round grate magnet with a "C" style diverter would be **GH**C04DC instead of the standard **GH**A04DC.*

Round Hopper Grate Magnets

Part # Number	Grate Dia.	# of Tubes	Square Inches	CuFt/ Hr.	Wt. lbs.	Flow Capacity By bulk (lbs/hr.)			Price Each
						40	50	60	
GHA04DC	4"	2	13	-	-	-	-	-	\$58.57
GHA06DC	6"	3	28	353	2.8	14,130	17,663	21,195	\$91.43
GHA08DC	8"	4	50	800	5	32,000	40,000	48,000	\$127.14
GHA10DC	10"	5	78	1,250	7.9	50,000	62,500	75,000	\$175.71
GHA12DC	12"	6	113	1,800	11.3	72,000	90,000	108,000	\$181.43
GHA14DC	14"	7	153	2,450	15.4	98,000	122,500	147,500	\$412.86
GHA16DC	16"	8	201	3,200	20.1	128,000	160,000	192,000	\$481.43
GHA18DC	18"	9	254	4,050	25.5	162,000	202,500	243,500	\$527.14
GHA20DC	20"	10	314	5,000	31.4	200,000	250,000	300,000	\$577.14
GHA22DC	22"	11	380	6,050	38	242,000	302,500	363,000	\$651.43
GHA24DC	24"	12	452	7,200	45.2	288,000	360,000	432,000	\$745.71
GHA26DC	26"	13	530	8,450	53	338,000	422,500	507,000	\$874.29
GHA28DC	28"	14	615	9,800	61.5	392,000	490,000	588,000	\$912.86
GHA30DC	30"	15	706	11,250	70.6	450,000	562,500	675,000	\$997.14
GHA32DC	32"	16	804	12,800	80.4	512,000	640,000	768,000	\$1,088.57

Square Hopper Grate Magnets

Part # Number	Length* Inches	# of Tubes	Square Inches	CuFt/ Hr.	Wt. lbs.	Flow Capacity By bulk (lbs/hr.)			Price Each
						40	50	60	
SGHA04DC	4	2	16	200	1.6	8,000	10,000	12,000	\$77.14
SGHA06DC	6	3	36	450	3.3	18,000	22,500	27,000	\$120.00
SGHA08DC	8	4	64	800	5.5	32,000	40,000	48,000	\$177.14
SGHA10DC	10	5	100	1,250	8.4	50,000	62,500	75,000	\$238.57
SGHA12DC	12	6	144	1,800	11.4	72,000	90,000	108,000	\$304.29
SGHA14DC	14	7	196	2,450	15.8	98,000	122,500	147,000	\$404.29
SGHA16DC	16	8	256	3,200	20	128,000	160,000	192,000	\$545.71
SGHA18DC	18	9	324	4,050	25.2	162,000	202,500	243,000	\$667.14
SGHA20DC	20	10	400	5,000	30.3	200,000	250,000	300,000	\$825.71
SGHA22DC	22	11	484	6,050	36.7	242,000	302,500	363,000	\$931.43
SGHA24DC	24	12	576	7,200	43.1	288,000	360,000	432,000	\$1,031.43
SGHA26DC	26	13	676	8,450	50.5	338,000	422,500	507,000	\$1,104.29
SGHA28DC	28	14	784	9,800	58.2	392,000	490,000	588,000	\$1,284.29
SGHA30DC	30	15	900	11,250	66.5	450,000	562,500	675,000	\$1,411.43

Granulator Plate Magnets

Feed Tray Magnet



INTRODUCTION:

Protect your regrind operation from tramp metal contamination with our powerful Granulator Plate Magnets. These magnets are designed for easy installation in your granulator's feed tray and are an economical way to prevent tramp metal from damaging your equipment and contaminating your product.



FEATURES:

- Stainless steel, all welded construction
- Low profile design for smooth product flow over the face of the magnet
- Easy 4 bolt installation with mounting hardware (included)

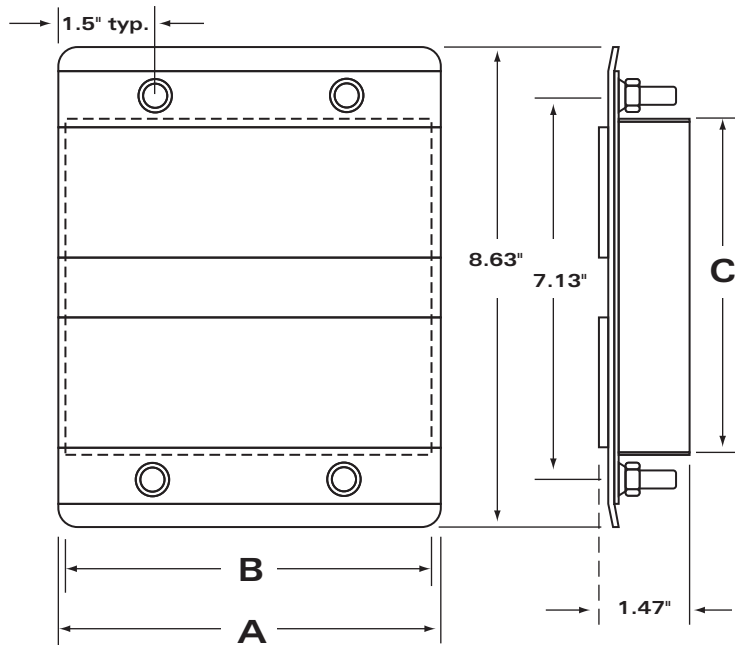

SPECIFICATIONS:

- 300 series stainless steel housing
- 400 series stainless steel poles
- 1/4-20 stainless steel cap screws and lock nuts provided for installation

INSTALLATION:

- Cut an opening in your feed tray
- Remove the mounting hardware from the magnet
- Set the magnet in the opening in the feed tray and mark the location of the mounting holes
- Remove the magnet and drill the four mounting holes into the feed tray
- Set the magnet back into the opening, insert the cap head screws into the mounting holes, thread the nuts onto the screws from the bottom of the feed tray and tighten appropriately

Part Number	Overall Width (A)	Magnet Width (B)	Magnet Width (C)	Price
GPM0550	5.50"	5.10"	6.25"	\$117.14
GPM0750	7.50"	7.10"	6.25"	\$138.57
GPM0950	9.50"	9.2"	6.25"	\$162.86
GPM1150	11.50"	11.10"	6.25"	\$190.00
GPM1300	13.00"	12.60"	6.25"	\$205.71
GPM1500	15.00"	14.60"	6.25"	\$215.71
GPM1700	17.00"	16.60"	6.25"	\$232.86
GPM1900	19.00"	18.60"	6.25"	\$244.29
GPM2100	21.00"	20.60"	6.25"	\$260.00
GPM2300	23.00"	22.60"	6.25"	\$281.43

PowerLift™ Magnets

Rare Earth Lift Magnets

These compact yet powerful Rare Earth lift magnets can be used on flat or round surfaces and contain an internal release devise that does not contact or damage the surface of the part being lifted. Permanent magnetic lifts eliminate the fear of dropping the load being lifted due to power failures.



- Lightweight Rare Earth design
- Lifts flat or round loads over 1" thick
- Easy manual release does not contact the load

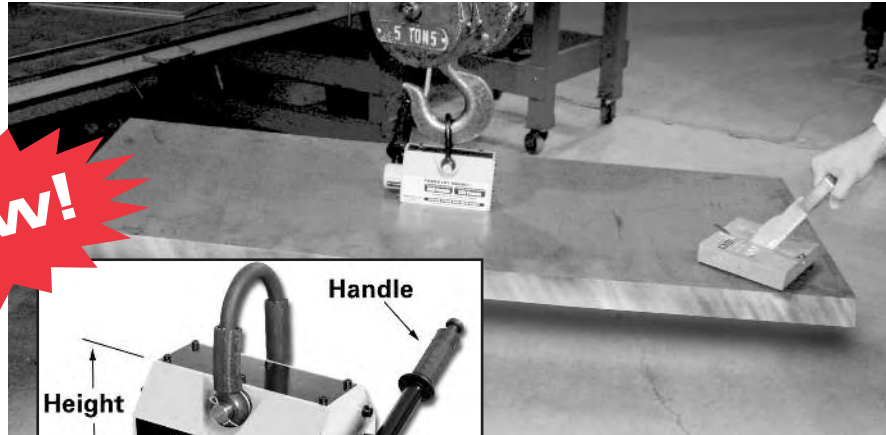

New!

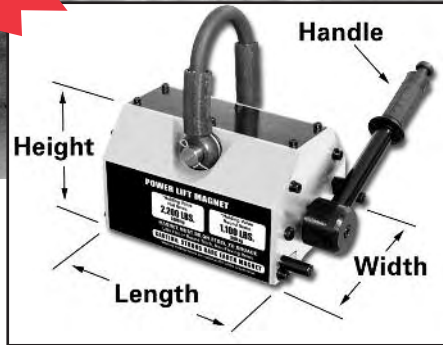

Use PowerLift™ magnets with Sheet Handlers for guiding large steel plates into position.

Model No.	Holding Value		Length In.	Width In.	Height In.	Handle In.	Wt. Lbs.	Price ea.
	*Flat Items	**Round Items						
PL220RE	220 Lbs.	110 Lbs.	3.62	2.44	2.63	4.96	7	\$253.39
PL660RE	660 Lbs.	330 Lbs.	6.38	3.62	3.58	6.1	22	\$606.67
PL1300RE	1,300 Lbs.	660 Lbs.	9.03	4.8	4.6	7.72	53	\$820.91
PL2200RE	2,200 Lbs.	1,100 Lbs.	9.13	6.93	6.41	11.22	110	\$1,582.00
PL4400RE	4,400 Lbs.	2,200 Lbs.	14.88	9.21	8.34	16.77	276	\$2,821.00

***PowerLift Holding Values are stated at 33% of the actual value for a 3 to 1 safety factor.**

Stated Value	Model No.	Holding Value & Max. Sheet Size for Specified Material Thickness					
		3/16"	1/4"	3/8"	1/2"	3/4"	1"
220 Lbs.	PL220RE	125 Lbs. [4'x4']	180 Lbs. [4'x4']	220 Lbs. [4'x4']	220 Lbs. [3'x3']	220 Lbs. [2'x3']	220 Lbs. [2'x2.5']
660 Lbs.	PL660RE	180 Lbs. [4'x6']	270 Lbs. [4'x6']	500 Lbs. *[4'x8']	615 Lbs. *[4'x8']	660 Lbs. [4'x5']	660 Lbs. [4'x4']
1300 Lbs.	PL1300RE	NA	NA	NA	800 Lbs. *[4'x8']	1300 Lbs. *[4'x8']	1300 Lbs. [4'x8']
2200 Lbs.	PL2200RE	NA	NA	NA	NA	970 Lbs. *[4'x8']	1445 Lbs. [4'x8']

*These maximum sheet sizes are selected due to the sag characteristics of the specified sheet. All other maximum sheet sizes are recommended due to the weight of the specified sheet. The item to be lifted must cover the entire length and width of the magnetic poles to properly engage and release the part.

When lifting sheets over 4' x 8', use 2 or more lifts on a spreader bar to prevent sheet flexing, sagging or peel-off. Material less than 3/8" thick is susceptible to magnetic bleed through, resulting in two sheets being lifted at once.

** Round Item Holding Values are based on ideal conditions. Pipe length, wall thickness diameter and surface condition can all effect the magnets performance.

Please consult the factory before specifying these magnets for use on round materials.

New!

Great News!

Bunting® is now offering rare earth magnets on all housings for the same price as the standard ceramic magnets! This means you get the same great Bunting® quality with a free extraordinary upgrade!



featuring the best of:

Northern Supply (800-365-6565) • Nickerson Machinery (800-821-9534) • OHS (Ontario-888-809-7050/Quebec-888-475-9224)

Bunting® Drawer Magnets

The Industry Standard for Extruders, Injection, and Blow Molding Equipment

TRAP TRAMP METAL

Protect Product Purity and Equipment with Bunting Permanent Magnetic Drawer Filters and In-line Separators

You can buy a bewildering variety of metal separation products from dozens of suppliers these days. As you might expect, cost and performance vary widely. So it pays to choose with care.

You may be surprised to discover how reasonably priced our separation equipment is especially given its reputation for being the best. All Bunting products featured in this brochure use powerful permanent magnets and provide dependable protection year after year with little or no maintenance. Bunting Permanent Magnetic protection won't "wear out", either. In fact, products featured in this catalog will still be working reliably long after your present molding machines and conveying equipment have been replaced.

So count on Bunting for effective, economical permanent magnetic separation. We're leaders in the field, first with significant innovations- like the original No-Spill™ Slide Gate, and now with redesigned magnetic drawer filters and Power Balanced Magnetic Cartridges™ engineered for increased holding force and collection area.

You'll find Bunting products widely used to reduce tramp iron contamination not only in plastics processing and manufacturing but in the food, chemical, and bulk solids industries as well. For over 30 years, American industry has relied on Bunting as a single-source



Model FF4600-PLS
(Shown with optional rear dump tube & liquid port)



Model FF4400-PL

supplier for the best in magnetic separation equipment.

VERSATILE DESIGN

For Molding Machines, Extruders and Many other applications

Protection Plus. Process material makes direct contact with a double row of magnetic cartridges-which provide dependable, constant magnetic protection that will not wear out. FF Series Magnetic Drawer Filters offer proven protection at key points... between bag dumps and conveying lines, at weigh stations cyclone receivers, hoppers, mixers, and other locations where contaminants jeopardize production runs and equipment. All Bunting Drawer Magnets now have greater surface holding force to capture tramp metal better than ever before. That means more complete removal of contaminants and less chance of "wipe-off."

Standard Bunting Ceramic V Magnets have the power to handle even many hard-to-attract fines. They have a higher maximum energy product and flux density than Ceramic VIII material and are the ideal choice for most separation applications. But when contaminants are extremely fine or weakly magnetic, specify Bunting high-energy rare earth magnets to get the job done.



LIFETIME GUARANTEE

We guarantee the durability and performance of Bunting Drawer Magnets for as long as you own them against defects in materials and workmanship. For years Bunting Drawer Magnets have been the first and most popular choice worldwide. Now they're even better, thanks to our powerful magnetic cartridges and heavy-duty drawer design. Both are included in our lifetime guarantee

Drawer Magnets -Not Drilled

Bunting®



(Picture shown with optional rear dump tube & liquid port)



NO WAITING FOR SAVING!!

These units have standard flange sizes so you can drill them to fit your machine and put them to work right away! Bunting is far and away the most popular drawer magnets in plastics! Don't settle for some look-alike brand, get the real thing, at real savings, right now!!

Order Number	Drawer Model	*	Top/Bottom Flange Size	Top Opening	Bottom Opening	Price Each	
						1-5	6+
DR1600D	LP1600PL	Low Profile	6" x 6" sq.	4 1/4" dia.	2 7/8" dia.	\$331.00	\$321.07
DR2100D	FF4600PLS	w/ Slide Gate	6" x 6" sq.	4 1/4" dia.	2 7/8" dia.	\$485.00	\$470.45
DR2200D	FF4600PLS	w/ Slide Gate	8" x 8" sq.	4 1/4" dia.	2 7/8" dia.	\$485.00	\$470.45
DR3500D	FF4800PLS	w/ Slide Gate	8" x 8" sq.	6" dia.	5 1/2" dia.	\$649.00	\$629.53

*Also drawings for model numbers: FF4600-PL, LP1600-PLS, LP1600-PL, FF4400-PLS

**Also drawings for model numbers: FF4600-PL, LP1600-PLS, LP1600-PL

***Also drawings for model numbers: LP1600-PLS, LP1800-PLS

Hopper Magnets -Grate Style

Bunting Grate-Style Hopper Magnets

come in a variety of shapes and sizes for use in round, square, or rectangular hoppers, chutes, housings, and bins. They are ideal for trapping tramp iron and ferrous objects such as nuts and bolts in free-flowing materials conveyed by gravity. Selection Tip: Grates should have at least twice the cross-sectional area of the hopper outlet opening.

Standard units feature 1" diameter Bunting Power-Balanced Magnetic Cartridges™ encased in 304 stainless steel and mounted on 2" centers-with optional rod or angle baffles to help direct product flow over the cartridges. Standard grate diameters range from 4" to 36".

Other sizes and rare earth models are available on request.

Square-tube cartridges with Ceramic V Magnets are available in square or rectangular stainless steel frames. Because they have an especially strong magnetic field that allows mounting on 4" centers, they're ideal for use where bridging may be a problem. Rare earth models are also available.

Bunting®

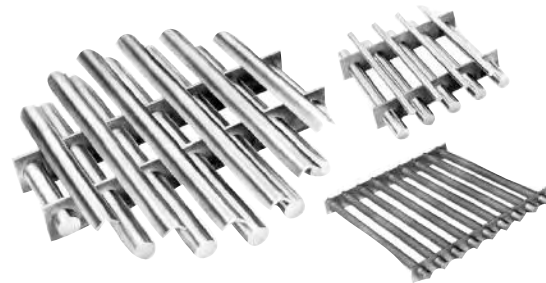

Round Hopper Magnets

Size	Part#	Price Each	
		1-5	6+
4"	GR4ACR	\$75.00	\$72.75
6"	GR6ACR	\$114.00	\$110.58
8"	GR8ACR	\$162.00	\$157.14
10"	GR10ACR	\$222.00	\$215.34
12"	GR12ACR	\$284.00	\$275.48

Square Hopper Magnets

Size	Part#	Price Each	
		1-5	6+
4"x 4"	GS4ACR	\$97.00	\$94.09
6"x 6"	GS6ACR	\$153.00	\$148.41
8"x 8"	GS8ACR	\$224.00	\$214.28
10"x 10"	GS10ACR	\$304.00	\$294.88
12"x 12"	GS12ACR	\$387.00	\$375.39

featuring the best of:

Northern Supply (800-365-6565) • Nickerson Machinery (800-821-9534) • OHS (Ontario-888-809-7050/Quebec-888-475-9224)

Drawer Magnets -Standard

Bunting®

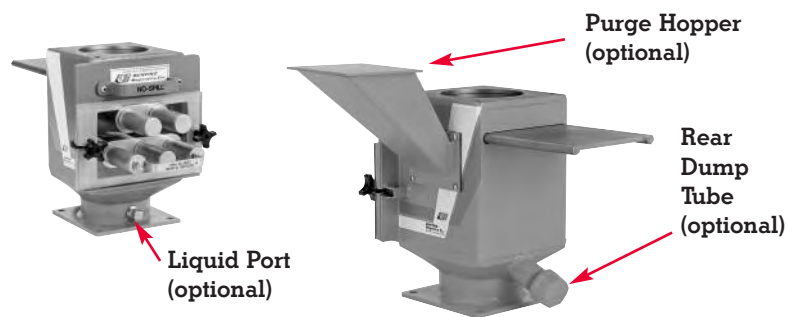

STAINLESS STEEL, ALNICO, AND RARE EARTH DRAWER MAGNETS

Our Stainless Steel Drawer Magnet housing is the right choice for corrosion resistance or when "clean room" standards must be met. If your process line handles resins heated to exceptionally high temperatures, order your magnetic drawer filter equipped with Bunting Alnico Magnets. Their magnetic strength will not diminish in temperatures as high as 1000°F.

If your application involves extremely small metal fines or contaminants that are only marginally magnetic, you may need the extra magnetic energy of rare earth magnets. Rare earth drawer filters are supplied with stainless steel housings to prevent the entire assembly from becoming magnetized by these extremely powerful magnets. Both stainless steel and stainless steel/rare earth models are available in several standard sizes and can also be custom made for your application.

PURGE HOPPER

Our magnetically protected Purge Hopper speeds clean-out of your equipment when changing color or compound. It also lets you quickly purge the machine and hand feed new material for a test or a short run without sacrificing magnetic protection or taking the time to empty your hopper.

REAR DUMP TUBE

This option lets you divert and collect material remaining in the hopper when a run has been completed, without running it through your molding equipment.

LIQUID PORT

The Liquid Port allows you to inject color additive into the resin. It's especially convenient for trial runs, short runs, or prototyping. The port can also be used to hold a temperature probe.

Custom Drawer Magnets

Model Number	Throat Size*	Price Ea. -Combine For Discount	
		1-5	6+
FF4400PL	1 3/4" or smaller	\$375.00	\$363.75
FF4600PL	1 7/8" or 3 7/8"	\$459.00	\$445.23
FF4800PL	4" to 6"	\$590.00	\$572.30
FF4100PL	6 1/8" to 8"	\$783.00	\$759.51

* Side to Side (Square) or Diameter (Round)

Custom Drawer Magnets w/ Slide-Gate

Model Number	Throat Size*	Price Ea. -Combine For Discount	
		1-5	6+
FF4400PLS	1 3/4" or smaller	\$414.00	\$401.58
FF4600PLS**	1 7/8" or 3 7/8"	\$515.00	\$499.55
FF4800PLS**	4" to 6"	\$665.00	\$645.05
FF4100PLS	6 1/8" to 8"	\$846.00	\$820.62

* Side to Side (Square) or Diameter (Round)

**In stock with standard flange sizes- Not drilled

Accessories

For Drawer Magnets

Add to Drawer Magnet Price		
Item	1-5	6+
Purge Spout	\$79.00	\$76.63
Dump Tube	\$22.00	\$21.34
Liquid Port	\$22.00	\$21.34

Use
Worksheet
on page 54

All Types are also available in SELF-CLEANING MODELS

Save time two ways as you protect product purity and equipment.

You can clean it in place with one quick pull or remove the whole drawer assembly for safe off-the-machine maintenance. Bunting Drawer Magnets are the first to offer such convenient cleaning.

Each self-cleaning unit has extra-long magnetic cartridges that fit inside stainless steel sleeves attached to the see-through

polycarbonate drawer front. Tramp metal collects on sleeve surfaces and falls from the sleeves as they are pulled clear of the magnetic cartridges and the drawer housing. No wiping or brushing required.

Now you can upgrade Bunting Standard Drawer Magnets by replacing the drawer module. Self Cleaning Drawer Modules are available to retrofit all new FF Series Models 4400, 4600, 4800, and 4100 (with or without Slide Gate option) manufactured after August 1, 1989. Just specify your Drawer Magnet model number when ordering.

Ask our knowledgeable sales people for more information.



Drawer Magnets

Bunting®

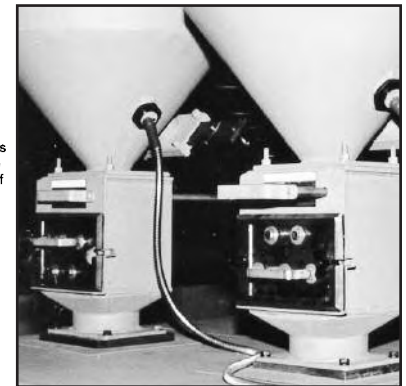
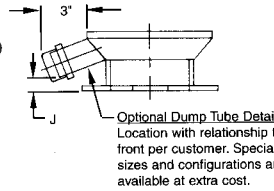
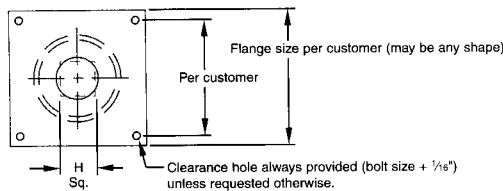
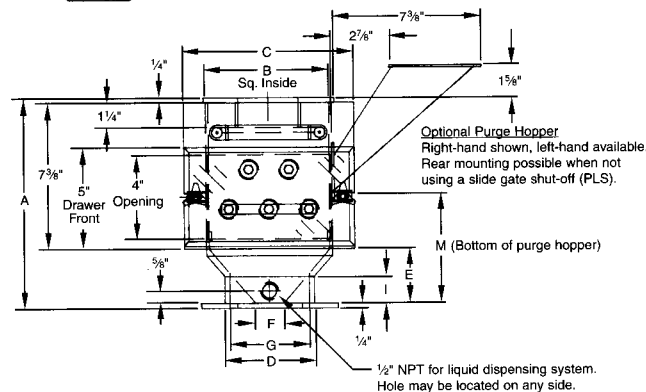
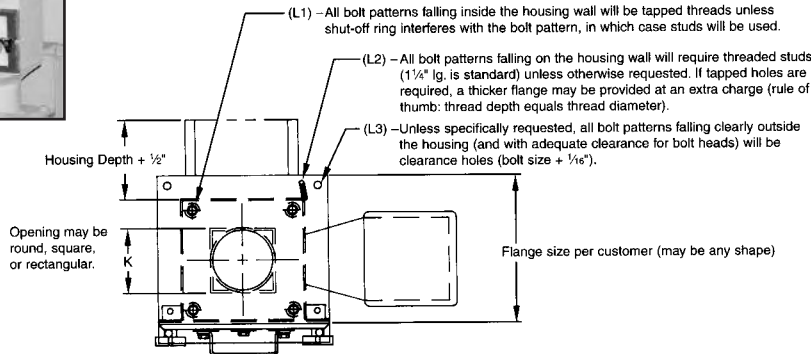

A

Easy Installation

Each of the four standard FF Series units is available with the original No-Spill™ Slide Gate - Bunting designed and patented - to provide safer and more convenient cleaning. All models are also available with self-cleaning drawer modules. Flanges are pre-drilled to OEM or customer specifications. Be sure to request the options, flange specifications, and hole locations you want when ordering. Standard and self-cleaning models now have identical housings. So standard units built after August 1, 1989, can be retrofit for self-cleaning operation simply by ordering a corresponding self-cleaning drawer module.

Dimensions

Model	FF4400PL/PLS	FF4600PL/PLS	FF4800PL/PLS	FF4100PL/PLS
A	10-1/2"	10-5/8"	10-7/8"	Varies
B	4 x 4"	6 x 6"	8 x 8"	10 x 10"
C	6-1/2"	8-1/2"	10-1/2"	12-1/2"
D	2-5/8"	4-3/8"	6-3/8"	Varies
E	2-5/8"	2-3/4"	3	Varies
F	7/8"	1-3/4"	3-1/8"	Varies
G	2-1/8"	3-7/8"	6	Varies
H	1-1/2"	2-3/4"	4-1/4"	Varies
I	1-11/32	1-5/16"	1-11/32"	Varies
J	3/8"	7/16"	3/4"	Varies
K	3"	5"	6-3/4"	8-3/4"
L1 L2 L3	Per	Customer	Specifications	
M	6 - 3/8"	6-1/2"	6-3/4"	Varies

featuring the best of:

Northern Supply (800-365-6565) • Nickerson Machinery (800-821-9534) • OHS (Ontario-888-809-7050/Quebec-888-475-9224)

Drawer Magnets -Low Profile

Bunting®

When headroom is critical,

you need Bunting's Low Profile Drawer Magnet. No other drawer magnet can compare to Bunting's proven design in a space-saving 5-11/16" overall height. You get a single row of our exclusive Power-Balanced Permanent Magnetic Cartridges, clear polycarbonate drawer front, and rigid 10-gauge steel construction--the same features that make our standard drawer magnets far and away the most

popular in the industry. Where you have additional clearance, you can even install these units with our original No Spill™ Slide Gate option. Rare earth magnetic cartridges are also available to trap and hold extremely fine or marginally magnetic ferrous material. We'll pre-drill the unit's rugged 1/4" thick flanges to your specifications at no extra charge.

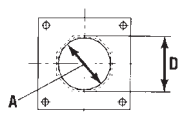
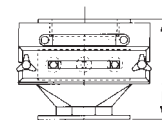
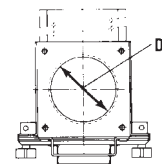

- S** Interior Size
- H** Height
- D1** Diameter of top flange opening
- D2** Maximum transition Diameter
- A1-A5** Standard throat diameters

Model	S	H	D1	D2	A1	A2	A3	A4	A5	Price Each	
										1-5	6+
LP1600PL ▼	6x6	5 11/16	4	4 3/8	2	2 3/8	2 7/8	3 3/8	3 7/8	\$354.00	\$343.38
LP1600PLS ❖ ▼	6x6	7 1/4	4	4 3/8	2	2 3/8	2 7/8	3 3/8	3 7/8	\$412.00	\$399.64
LP1800PL	8x8	5 15/16	6	6 3/8	4	4	5	5	6	\$462.00	\$448.14
LP1800PLS ❖	8x8	7 1/2	6	6 3/8	4	4	5	5	6	\$542.00	\$525.74

❖ Slide-Gate ▼ In stock with standard flange sizes- Not drilled

Mini-Loader Magnet

Bunting®

Just-In-Time Magnetic Separation

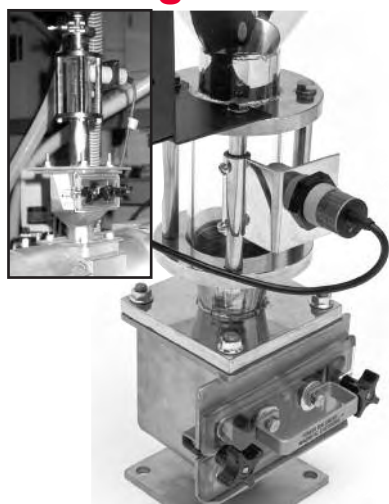

- High Quality
- Easy Mounting
- 2 styles available

Many plastics processors are turning to smaller volume, closed-loop systems. These "Just-in-Time" systems dry resin at a central point and then convey small amounts to the molding machine. Seeing a special need for magnetic protection against ferrous contaminants in such operations, Bunting Magnetics now manufactures two drawer magnets specifically designed for these systems.

Power Balanced Magnetic Cartridges® and an O-ring seal to prevent air leaks. The FFV Series of drawer magnets are designed to withstand pressures up to 15 in-hg without leakage. A clear polycarbonate drawer front allows easy monitoring of resin flow and tramp metal collection. The cartridge drawer pulls out of the housing for easy cleaning.

The FFV-1400-PL has a housing manufactured from 12-gauge mild steel. It captures ferrous contaminants with two Ceramic magnetic cartridge and has a rod baffle to direct the flow of resin over the cartridges. In applications where extremely small fines or weakly magnetic contaminants are a problem, this drawer magnet can be ordered with two high-energy Rare Earth magnetic cartridges. The housing is then manufactured from 302/304 stainless steel and is designated by the part number FFSV-1400-PLNE. This unit has a 20 oz. capacity, a maximum inlet diameter of 3 inches, and a maximum outlet diameter of 2 3/4".

Mounted on the throat of the processing machine, both of these drawer magnets come with Bunting's exclusive

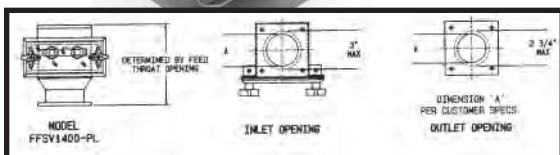

Part Number	Description	Price Ea.	
		1-5	6+
FFV1400PL	Mild Steel Unit	\$431.00	\$418.07
FFSV1400PL	Stainless Steel Unit	\$501.00	\$485.97

Granulator Plate Magnets

Bunting®

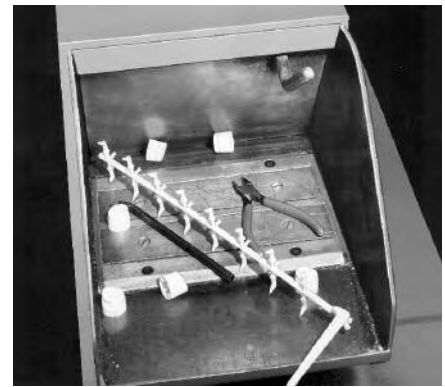

A

Simple, Rugged Design & Construction for A Lifetime of Use.

Your regrind operation runs an extra risk of tramp metal contamination. Now you can protect it easily and economically with Bunting Grinder Plate Magnets. They install easily in your granulator's feed tray to attract and hold ferrous metal before it can reach internal parts. Grinder vibration won't shake even misplaced hand tools or large ferrous trash from this powerful Ceramic V permanent magnet.

Each Grinder Plate Magnet is manufactured with a rugged cast aluminum frame. Back plate and magnetic pole face are made of mild steel. Specify grinder feed tray dimensions when ordering. To install, just cut an opening in the feed tray and bolt the pre-drilled flange of the magnet to the tray, using the holes and hardware provided.

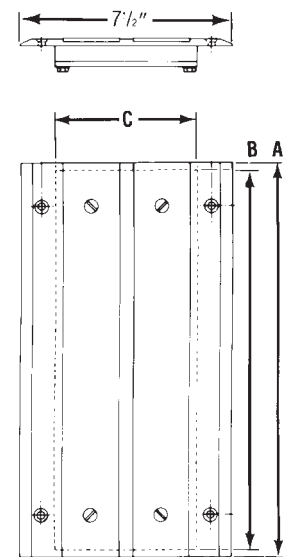

Bunting Granulator/Grinder Plate Magnets

Size	Part#	Dimensions			Price Ea.	
		A	B	C	1-5	6+
5 1/2" x 7 1/2"	GPM555	5 1/2"	5"	5"	\$124.00	\$120.28
7 1/2" x 7 1/2"	GPM757	7 1/2"	7"	5"	\$147.00	\$142.59
9 1/2" x 7 1/2"	GPM959	9 1/2"	9"	5"	\$174.00	\$168.78
11 1/2" x 7 1/2"	GPM11511	11 1/2"	11"	5"	\$203.00	\$196.91
13" x 7 1/2"	GPM13125	13"	12 1/2"	5"	\$217.00	\$210.49
15" x 7 1/2"	GPM15145	15"	14 1/2"	5"	\$232.00	\$225.04
17" x 7 1/2"	GPM17165	17"	16 1/2"	5"	\$246.00	\$238.62
19" x 7 1/2"	GPM19185	19"	18 1/2"	5"	\$256.00	\$248.32
21" x 7 1/2"	GPM21205	21"	20 1/2"	5"	\$277.00	\$268.69
23" x 7 1/2"	GPM23225	23"	22 1/2"	5"	\$303.00	\$293.91

featuring the best of:

53

Hopper Magnet Worksheet

This is an Order

This is a Request for a price quote

Authorized Signature _____

Company _____

Name _____

P.O. Number _____

Phone _____

Address _____

Fax _____

City/State/Zip _____

Date _____

Part # _____ Qty. Ordered _____ Price Ea. _____ Total P.O. \$ _____

Optional Equipment:

- With slide gate shut-off
- With tapped hole for liquid dispensing system
- With purge hopper R.H. Slide
- With purge hopper L.H. Slide
- With discharge dump tube rear or other
- _____

INFORMATION REQUIRED FOR ORDERING OR QUOTATION REQUEST

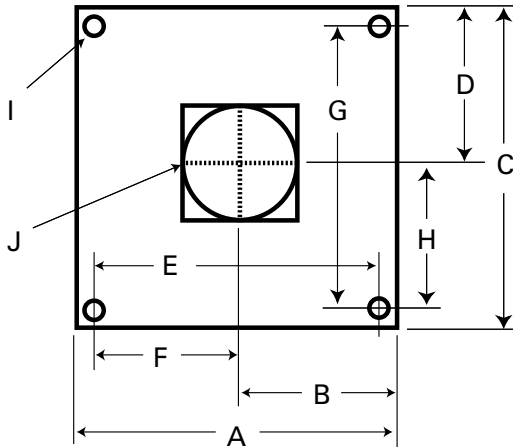

**BOTTOM FLANGE
OPERATOR SIDE (FRONT)**

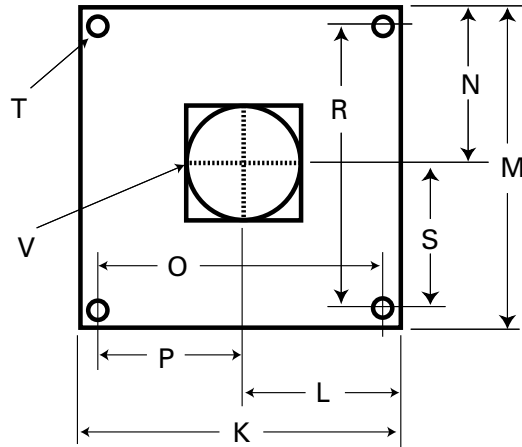

**TOP FLANGE
OPERATOR SIDE (FRONT)**

A _____ H _____
 B _____ I _____
 C _____ J = OPENING _____
 D _____ ROUND _____
 E _____ SQUARE _____
 F _____ RECTANGLE: _____
 G _____ FRONT TO BACK _____
 SIDE TO SIDE _____

K _____ S _____
 L _____ T* _____
 M _____ V - OPENING _____
 N _____ ROUND _____
 O _____ SQUARE _____
 P _____ RECTANGLE: _____
 R _____ FRONT TO BACK _____
 SIDE TO SIDE _____

Make of Press _____ Serial No. _____

Model _____ Screw Size _____ Ounce _____

Make of Hopper _____ Hopper Capacity _____ Lbs. _____

Metal Detection System

Bunting®



Reliable Automatic Detection and Rejection of Metal Contaminants. The Bunting HS Series Metal Detector is an electronic metal detection and separation system designed to automatically detect and reject all metals in free-flowing, gravity-fed bulk materials, such as plastic granules, flakes, pellets, feeds, grains, cereals, and more.

Precise Control and Operation. Equipped with a single-coil, high-frequency detection system and a rapid air-powered rejection flap, Bunting's HS units detect and remove ferrous and nonferrous metallic contaminants from free-flowing bulk materials. What's more, features like adjustable sensitivity give you complete control over product quality and ensure precise detection with minimal loss of good product.

Compact and Durable. Bunting HS Detectors are compact and durable. They have a single electronics board and are completely enclosed in

dust-tight, painted steel housings, with four mounting brackets included.

Virtually Maintenance Free. Install Bunting's HS Detector into your free-fall processing system. It is self-monitoring and virtually maintenance free, so you can literally set it and forget it. The HS continuously monitors the sensor; the air pressure (with a compressed air filter/regulator to maintain air quality to the air-actuated solenoid); the power supply (self-adjusting to any voltage from 110V to 230V); and the detector's mechanical functions. **These units are also self-diagnosing and require no lubrication!**

Specifications:

Housing: Unit is completely enclosed in a steel cabinet with four mounting brackets. Painted surface color: RAL 1013 Pearl White. Withstands loads up to 250 lbs. allowing for direct mounting of mixers, batch feeders, etc. Undrilled mounting flange included.

Detection: Single Coil, high frequency

Electronics: Single electronics board. 110-230V single phase.

Reject: Air-operated, lifetime-lubricated reject flap.

Monitoring: Sensor, air pressure, and reject flap position continuously monitored.

Air: 70 psi minimum. Air pressure regulator with automatic water drain.

Operating Temperature: 154° F maximum

Metal Detector/Seperator		
Part No.	Description	List Price
MDHS9050	Metal Detector w/ 1.96" Inlet diameter	\$4,110.00
MDHS9100	Metal Detector w/4" Inlet diameter	\$5,444.00
MDHS9150	Metal Detector w/6" Inlet Diameter	\$8,325.00
MDHS9200	Metal Detector w/8" Inlet Diameter	\$8,536.00
Options for Metal Detector/Seperator		
MDHSF050	Funnel for MDHS9050	\$373.00
MDHSF100	Funnel for MDHS9100	\$467.00
MDHSF150	Funnel for MDHS9150	\$724.00
MDHSF200	Funnel for MDHS9200	\$724.00
DR9050D	6" Square Double Row Drawer magnet for MDHS9050	\$450.00
MDHS0050-1600	Low Profile series 6" Square single row drawer magnet for MHDS-9050	\$425.00
DR9050DNHI	6" Square Double row drawer magnet for MDHS-9050 (For "Hi-Intensity" Loads)	\$1,098.00
DR9100D	6" Square Double Row Drawer magnet for MDHS-9100	\$450.00
MDHS0100-1600	Low Profile series 6" Square single row drawer magnet for MHDS-9100	\$425.00
DR9100DNHI	6" Square Double row drawer magnet for MDHS-9100 (For "Hi-Intensity" Loads)	\$1,098.00

featuring the best of:

55

A